



# STEEL DOORS

**NEW.** Fire- and acoustic-rated doors with frameless glazing and thermal break

**HÖRMANN**





4

Good reasons  
to try Hörmann  
sheet steel doors.



8

Application areas.

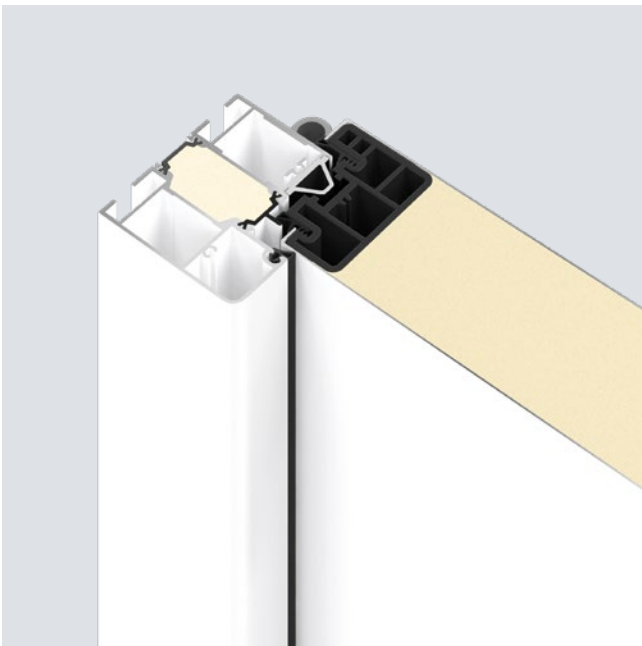

20

Versions.  
Equipment.  
Technology.

# Responsibility for generations

The Hörmann family business has over 85 years of experience as a construction component specialist. This gives us an obligation to both current and future generations. That's why environmental responsibility plays such an important role for us. With this in mind, we develop innovative solutions for sustainable products and intelligent environmental protection.



## “A GOOD REPUTATION MUST BE EARNED.”

August Hörmann

In keeping with the tradition started by the company’s founder, the Hörmann brand is a true promise of quality and, with sales of over 20 million doors and operators, is one of Europe’s most successful suppliers. Due to the comprehensive international sales and service network, Hörmann is your strong partner for high-quality construction components.



**WE THINK AND ACT GREEN.** As a family business, we are very conscious of our responsibility to future generations and offer all products for residential construction CO<sub>2</sub>-neutral as standard. The Hörmann sustainability strategy aims to reduce and avoid emissions. We cover 100% of our electrical power needs at all European production sites\* with genuine green electricity from renewable sources. We also apply many other measures to reduce our consumption and save more than 75000 tonnes of CO<sub>2</sub> each year. We work with ClimatePartner to offset the remaining emissions by supporting certified climate protection projects.

\* Except for Maviflex in France



You can find further information at  
[www.hoermann.com/sustainability](http://www.hoermann.com/sustainability)



**ClimatePartner**  
certified product  
[climate-id.com/XNEBKC](http://climate-id.com/XNEBKC)



CO<sub>2</sub>  
measure  
reduce  
contribute

# Brand quality made in Germany



The family-owned company Hörmann offers all important construction components for building and renovating projects from a single source. We manufacture in highly specialised factories using state-of-the-art production technologies. Our employees work intensively on new products, continual further developments and improvements to details. The results are patents and unique products on the market.



**LONG-LASTING. GUARANTEED.** All doors are developed and manufactured by Hörmann. Endurance tests under real conditions ensure mature series products with Hörmann quality.



**Certified security features**  
up to resistance class RC4



**High acoustic insulation**  
Up to 42 dB



**Excellent thermal insulation**  
Up to 0.85 W/(m<sup>2</sup>·K)



**T30 / EI<sub>2</sub>30**  
Fire-retarding

### **BREAK-IN-RESISTANT RC 2 SECURITY FEATURES.**

The KSI 40-1 / KSI Thermo46 security doors are available with approved, break-in-resistant RC 2 security features as standard. For you, this means feeling even more secure in your own home.

**UP TO 49% IMPROVED THERMAL INSULATION.** You are looking for basement and side doors with the same thermal insulation as your entrance door? Then our KSI Thermo46 security door and MZ Thermo46 and MZ Thermo65 multi-purpose doors are the right choice for you: The MZ Thermo65 provides up to 49% better thermal insulation than conventional multi-purpose doors.

**EXPERTISE IN FIRE PROTECTION.** For decades, fire-rated doors have been providing ultimate security for boiler rooms, oil tank rooms or between the garage and house. These doors are the best example of how you can benefit from Hörmann's expertise in fire protection.

→ For further information, see from page 22.

# Security door KSI Thermo46

**EXTERNAL DOOR FOR BASEMENT, HEATED OUTBUILDINGS AND GARAGES WITH ACCESS TO THE HOUSE.** Thanks to the door leaf and frame with thermal break, security door KSI Thermo46 offers the best thermal insulation and reduces the risk of condensation forming in heated rooms. The break-in-resistant RC 2 security features mean you can also feel secure in your home.

→ For further information, see from page 24.







## Fire-rated door FS Thermo65

**EXTERNAL DOOR COMPLYING WITH FIRE PROTECTION REQUIREMENTS, FOR EXAMPLE, THE TRANSITION FROM THE GARAGE TO THE HOUSE.** The FS Thermo65 not only withstands a fire for at least 30 minutes but, thanks to a thermal break, it also offers up to 49% better thermal insulation and reduces the risk of condensation forming on the door leaf in heated rooms.

→ For further information, see from page 26.

# Multi-purpose doors

## MZ Thermo65 / MZ Thermo46

**EXTERNAL DOORS FOR BASEMENT, HEATED OUTBUILDINGS, GARAGES WITH ACCESS TO THE HOUSE AS WELL AS WORKSHOPS AND HOBBY ROOMS.** The MZ Thermo65 / MZ Thermo46 are more than just extremely robust. Thanks to the thermal break, they offer up to 49% better thermal insulation and reduce the risk of condensation forming in heated rooms. They are available with or without glazing as well as in numerous colours and with Decograin surface finish.

→ For further information, see from page 28.





## Acoustic-rated door Thermo65

**EXTERNAL DOOR FOR BLOCKS OF FLATS.** Particularly in the case of doors for walkways in residential complexes, it is important to have sufficient acoustic insulation and good thermal insulation, as they allow external access, for example, to individual flats in a residential building. The Thermo65 with acoustic rating category 3 and door leaf and frame with thermal break is ideal for this purpose.

→ For further information, see from page 28.



## Security door KSI 40-1

**EXTERNAL DOOR FOR BASEMENT, UNHEATED OUTBUILDINGS AND DETACHED GARAGES.** These areas of properties are often equipped with old doors that can be forced open in seconds. Always remember: if the basement door is open, the whole house is accessible. This is why we recommend the security door KSI 40-1 with standard security features for these areas.

→ For further information, see from page 30.

# Function door H3 OD

**INTERNAL DOOR / EXTERNAL DOOR FOR FIRE PROTECTION REQUIREMENTS, E.G. FOR THE TRANSITION FROM THE GARAGE TO THE HOUSE.** Due to fire hazards in garages, a fire-rated door between the house and garage is required by law. The H3 OD steel construction project door is the best choice for this sensitive area. On request, this door can also act as a seal against smoke and engine noise and additionally protects your family from burglars with its security features.

→ For further information, see from page 32.





## Fire-rated door H8-5

**INTERNAL DOOR FOR FIRE PROTECTION REQUIREMENTS.** The fire-rated door H8-5 is Europe's best-selling boiler room door and has been providing optimum safety for boiler rooms and rooms with oil tanks for decades.

→ For further information, see from page 34.

# Multi-purpose door MZ

**INTERNAL AND EXTERNAL DOOR FOR UNHEATED OUTBUILDINGS, TOOL SHEDS AND STORAGE AREAS.** Proven for over four decades, the multi-purpose door MZ is stable, durable and weather-resistant, making it ideal for inside and outside applications. The MZ comes in a single-leaf or double-leaf version and is available with glazing on request.

→ For further information, see from page 34.





## Multi-purpose door ZK **.NEW**

### **INTERNAL AND EXTERNAL DOOR FOR BASEMENTS, GARAGES OR**

**OUTBUILDINGS.** The multi-purpose steel door ZK is ideal for inside and outside applications. The thick rebate version provides an elegant door view that works particularly well with rebated internal doors. The door is also robust, dimensionally stable and durable. This is Hörmann quality at an attractive price.

→ For further information, see from page 36.



# Internal door ZK

**INTERNAL DOOR FOR BASEMENTS, CHILDREN'S BEDROOMS AND ACCESS TO UNRENOVATED LOFTS.** Over many years, ZK doors have proven themselves as robust doors in houses and blocks of flats. The double-leaf version impresses with a flush-fitting transition between the traffic leaf and the fixed leaf without a visible centre rail **.NEW**. The doors feature a robust design that does not warp and, thanks to their high-quality surface finish, they are durable, resistant to stains and therefore easy to clean.

→ For further information, see from page 38.





# Internal door OIT 40

**INTERNAL DOOR FOR OFFICE, WORKSHOP AND SCHOOL ROOMS.** The high-quality internal doors OIT 40 are particularly robust, dimensionally stable and durable. They are recommended for tough everyday use in industrial and commercial buildings, workshops, administrative buildings, schools and barracks. Thanks to the different infill variations, they also fulfil the special requirements of acoustic insulation and thermal insulation. The internal door OIT 40 can also be combined with the steel case frame VarioFix for easy fitting. The matching internal windows VarioFix provide more light in hallways.

→ For further information, see from page 38.





24



38



47









# Versions. Equipment. Technology.

- 22 Door overview
- 24 External doors with thermal break
- 30 External doors
- 32 Internal doors, external doors
- 38 Internal doors
- 40 Optional equipment
- 42 Preferred colours / Matt deluxe
- 47 Decograin surface finish
- 48 Size range
- 49 Sizing and fitting versions

# Door overview

Functions, performance characteristics, size ranges

Door type	KSI Thermo46	FS Thermo65	MZ Thermo65	MZ Thermo46	Thermo65 Acoustic insulation
Internal door					
 External door for unheated buildings					
 External door for heated buildings	■	■	■	■	■
<b>Version</b>	Single-leaf	Single-leaf	Single-leaf	Single-leaf	Single-leaf
 <b>T30 Fire-retarding</b>					
 <b>EI230 Fire-retarding</b>		★ ★ ★			
 <b>S200 Smoke-tight</b>		★ ★ ★			
 <b>Thermally insulated</b>	★ ★	★ ★ ★	★ ★ ★	★ ★	★ ★ ★
 <b>Acoustic-rated</b>	★	★ ★		★ ★	★ ★ ★
 <b>S<sub>a</sub> Sealed</b>		★ ★ ★			
 <b>Break-in-resistant</b>	★ ★		★	★	★ ★
<b>Door set</b>					
Door leaf thickness	46 mm	65 mm	65 mm	46 mm	65 mm
Sheet thickness	0.6 – 0.8 mm	0.6 – 0.8 mm	0.6 – 0.8 mm	0.6 – 0.8 mm	0.6 – 0.8 mm
Rebate type	Thick rebate	Thick rebate	Thick rebate	Thick rebate	Thick rebate
Door leaf and frame with thermal break	●	●	●	●	●
<b>Performance characteristics</b>					
Resistance class	RC 2				RC 2 (optional)
Thermal insulation	1.1 W/(m <sup>2</sup> ·K)	0.85 – 1.1 W/(m <sup>2</sup> ·K)	0.87 – 1.0 W/(m <sup>2</sup> ·K)	1.1 – 1.6 W/(m <sup>2</sup> ·K)	0.87 W/(m <sup>2</sup> ·K)
Acoustic insulation	Up to 29 dB	Up to 32 dB		Up to 32 dB	Up to 42 dB
Self-closing		C5			
Water tightness under heavy rain – opening inwards		3A			3A
Resistance to wind load		C3 / B3			
Air permeability		Class 2			Class 4
Differential climate behaviour		3 (c), 2 (d), 2 (e)			2 (d), 2 (e)
Climatic class					
Duty category					
<b>Fitting in</b>					
Brickwork	≥ 115 mm	≥ 175 mm	●	●	●
Concrete	≥ 100 mm	≥ 175 mm	●	●	●
Gas concrete			●	●	●
<b>Size range</b>					
Nominal size width	832 – 1250 mm	850 – 1250 mm	700 – 1250 mm	700 – 1250 mm	700 – 1250 mm
Nominal size height	1875 – 2250 mm	1750 – 2250 mm	1750 – 2250 mm	1750 – 2250 mm	1875 – 2250 mm

Main functions (as standard): ★★ ★ Top ★★ Very good ★ Good

Additional function (with corresponding equipment): ★★ ★ Top ★★ Very good ★ Good

KSI 40-1	H3 OD	H8-5	MZ	Multi-purpose ZK .NEW	ZK	OIT 40
■	■	■	■	■	■	■
■	■		■	■		
Single-leaf	Single-leaf	Single-leaf / hatch	Single- / double-leaf	Single-leaf	Single- / double-leaf	Single- / double-leaf
	★★★★	★★★★				
	★★★★					
	☆☆☆	☆☆☆				
★	★	★	★	★		★
	☆☆☆☆	★★	★★	★★		☆☆
	★★★					
★★	☆☆☆☆	★	★	★		☆☆
40 mm	65 mm	45 mm	45 mm	40 mm	40 mm	40 mm
0.8 mm	1.0 / 1.5 mm	0.9 mm	0.9 mm	0.8 mm	0.6 mm	0.8 mm
Thick rebate	Thin / thick rebate	Thin rebate	Thin rebate	Thick rebate	Thick rebate	Thick rebate
RC 2	RC 4 (optional)					RC 2 (optional)
1.7 W/(m <sup>2</sup> ·K)	1.5 – 1.7 W/(m <sup>2</sup> ·K)	1.7 W/(m <sup>2</sup> ·K)	1.7 W/(m <sup>2</sup> ·K)	1.6 W/(m <sup>2</sup> ·K)	2.1 W/(m <sup>2</sup> ·K)	1.7 W/(m <sup>2</sup> ·K)
	32 – 43 dB	Up to 39 dB	Up to 39 dB			Up to 38 dB
	C5					
	Unprotected 3A					
	C3					
	Class 4					
III					III	III
S					S	S
≥ 115 mm	≥ 115 mm	≥ 115 mm	●	●	●	●
≥ 100 mm	≥ 100 mm	≥ 100 mm	●	●	●	●
	≥ 150 mm		●	●	●	●
625 – 1250 mm	500 – 1500 mm	625 – 1000 mm	625 – 1250 mm	No special sizes	625 – 1250 mm	625 – 1250 mm
1700 – 2250 mm	500 – 2500 mm	800 – 2125 mm	1570 – 2134 mm	No special sizes	2000 – 2125 mm	2000 – 2125 mm

# External doors with thermal break

Security door KSI Thermo46

	KSI Thermo46
Fire-retarding	_____
Smoke-tightness	_____
Thermal insulation	★★
Acoustic insulation	★
Break-in resistance equipment	★★



**30% improved thermal insulation**  
compared to a conventional security door



**External door for heated rooms**

The classification of the individual doors shows you at a glance which functions the respective door fulfils and to what extent.

Main functions (as standard):  
 ★★★★★ Top   ★★ Very good   ★ Good

Additional function  
 (with corresponding equipment):  
 ★★★★★ Top   ★★ Very good   ★ Good





### The same thermal insulation as with entrance doors

These days, saving energy is important throughout the entire home. The door leaf, frame and threshold with thermal break prevent condensation forming in heated rooms. Thanks to the 46-mm thick door leaf **1** with PU rigid foam infill and the double seals on all four sides, the KSI Thermo46 has a thermal insulation value normally only found with entrance doors.

### Securing excellent properties

Basement and side doors are often weak spots when it comes to security. In this respect, the KSI Thermo46 offers the best equipment as well: 1 lock bolt **2** and 2 conical swing bolts with 2 additional security bolts **3** engage in the frame's lock plates and firmly pull the door shut. 3 further security bolts **4** and 3 guide rollers **5** on the hinge side make it practically impossible to force the door open.



**RC 2 security**  
Tested and certified

The opportunist burglar attempts to break open the locked door with simple tools within 3 minutes.



# External doors with thermal break

Fire-rated door FS Thermo65

	FS Thermo65
Fire-retarding	★★★★
Smoke-tightness	★★★★
Thermal insulation	★★★★
Acoustic insulation	★★
Break-in resistance equipment	



**49% improved thermal insulation**  
compared to a conventional fire-rated door



**External door for heated rooms**

The classification of the individual doors shows you at a glance which functions the respective door fulfils and to what extent.

Main functions (as standard):  
★★★★ Top   ★★ Very good   ★ Good

Additional function  
(with corresponding equipment):  
☆☆☆ Top   ☆☆ Very good   ★ Good

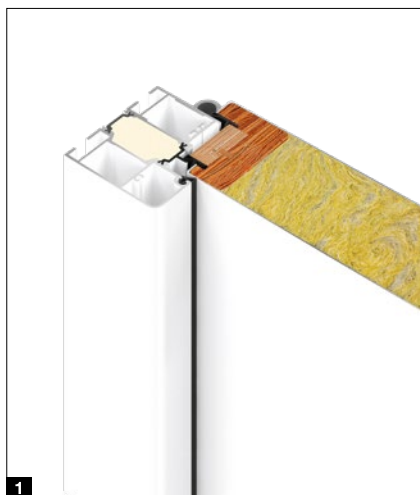

### Fire-rated door FS Thermo65

The 65-mm-thick door leaf **1** without glazing offers a particularly high  $U_D$ -value of up to  $0.85 \text{ W}/(\text{m}^2 \cdot \text{K})$  and excellent thermal insulation. The fire-rated door withstands a fire for at least 30 minutes, making it the ideal solution for the transition from the garage to your living area (e.g. entrance hallway).

### High thermal insulation

The door leaf of the fire-rated door FS Thermo65 is filled with mineral wool, the frame and threshold have thermal breaks. This and the all-round double seals on all four sides make sure the door is perfectly sealed and provides high thermal insulation.

### High-quality equipment

For self-closing, the fire-rated door FS Thermo65 is equipped with the Hörmann slide rail door closer HDC 35 **2** as standard. The doors can be optimally adjusted using the three-way adjustable guide rollers **3**.

### Individual door styles

The fire-rated doors FS Thermo65 are available in 4 styles each with single-point locking and black lever handle set **4** – **7** or with multiple-point locking and stainless steel handle HB 14-2 **8** or HB 38-2 **9**.

**4** Full-surface style

**5** Style with 7 ribs on exterior

**6** Style with 3 ribs on exterior

**7** Style with frameless glazing (Satinato) **.NEW**



**8** Stainless steel handle HB 14-2, handle length 330 mm

**9** Stainless steel handle HB 38-2, handle length 1000 mm

# External doors with thermal break

Multi-purpose doors MZ Thermo65 / MZ Thermo46, acoustic-rated door Thermo65

	MZ Thermo65	MZ Thermo46	Thermo65 Acoustic insulation
Fire-retarding			
Smoke-tightness			
Thermal insulation	★★★	★★	★★★
Acoustic insulation		★★	☆☆☆
Break-in resistance equipment	★	★	☆☆



## 49% improved thermal insulation

MZ Thermo65 compared to a conventional multi-purpose door



## External door for heated rooms

The classification of the individual doors shows you at a glance which functions the respective door fulfils and to what extent.

Main functions (as standard):  
 ★★★ Top   ★★ Very good   ★ Good

Additional function (with corresponding equipment):  
 ☆☆☆ Top   ☆☆ Very good   ★ Good



### High thermal insulation

Minimise heat losses permanently: The door leaf, frame and threshold with thermal break prevent condensation forming in heated rooms. The all-round double seals on all four sides make sure the doors are perfectly sealed and provide high thermal insulation.

### Stability and functionality

The doors are exceptionally stable and robust thanks to the fully filled door leaf. They can be optimally adjusted using the three-way adjustable guide rollers **3**.

### Multi-purpose doors MZ Thermo65 / MZ Thermo46

The 65-mm-thick door leaf **1** of the MZ Thermo65 impresses with a particularly high UD-value of up to  $0.87 \text{ W}/(\text{m}^2\cdot\text{K})$  and offers up to 49% better thermal insulation compared to conventional multi-purpose doors. The MZ Thermo46 has a 46-mm-thick door leaf **2** and provides a thermal insulation value of up to  $1.1 \text{ W}/(\text{m}^2\cdot\text{K})$ .

To enable you to use daylight in your workshop or hobby room, the MZ Thermo65 / MZ Thermo46 not only comes in the full-surface style THP 011 / TPS 011 (shown on left) but also in the glazed styles TPS 021S / THP 021S **4** with round-style frame **5** and Satinato glazing, THP 051S / TPS 051S **6** with profile-style frame **7** and Satinato glazing or TPS 051F / THP 051F **6** with clear glass.

### Acoustic-rated door Thermo65

The acoustic-rated door Thermo65 is available in a full-surface style **8** or in a style with frameless glazing **9**. **.NEW**. The 65-mm-thick door leaf impresses with a great  $U_D$ -value of up to  $0.95 \text{ W}/(\text{m}^2\cdot\text{K})$  and excellent acoustic insulation. With the standard threshold, the doors achieve acoustic rating category 3 (42 dB) and acoustic rating category 2 (37 dB) with the optional retractable bottom seal. They provide protection against street noise as well as wind and weather: the ideal door – not only for entrance doors in blocks of flats with walkways.



# External doors

## Security door KSI 40-1

KSI 40-1

Fire-retarding	
Smoke-tightness	
Thermal insulation	★
Acoustic insulation	
Break-in resistance equipment	★★



External door for unheated rooms

The classification of the individual doors shows you at a glance which functions the respective door fulfils and to what extent.

Main functions (as standard):  
 ★★★ Top   ★★ Very good   ★ Good

Additional function  
 (with corresponding equipment):  
 ☆☆☆ Top   ☆☆ Very good   ☆ Good



### Sturdy door leaf

The KSI 40-1 features a double-skinned, 40-mm-thick door leaf with 3-sided thick rebate and sheet steel on both sides (0.8 mm). The stability of the door leaf is a result of the all-round reinforcement frame and the mineral wool insert which is glued over the entire surface. A 3-sided EPDM seal **1** and double lip seal (incl. aluminium semi-circular threshold as a bottom edge) seal the door reliably. This means you can always rely on the door in terms of function and tightness. Hörmann offers this door as a complete door set with frame.

### High security

The standard security of the KSI 40-1 lets you and your family sleep peacefully, as it comes with pull-off protection and a drill-resistant security lever / knob handle set **2** and lock bolt **3**. The solid steel bolts **4** on the hinge side make it almost impossible to force the door open. The door is equipped with a 3-part hinge **5** as standard, and optionally available with a three-way adjustable VX hinge **6**. The KSI 40-1 has been tested in accordance with European standard DIN EN 1627 on the opening and closing side and has resistance class 2.



**RC 2 security**  
Tested and certified

The opportunist burglar attempts to break open the locked door with simple tools within 3 minutes.



# Internal doors, external doors

Function door H3 OD

	Multi-function H3 OD
Fire-retarding	★★★
Smoke-tightness	☆☆☆
Thermal insulation	★
Acoustic insulation	☆☆☆
Break-in resistance equipment	☆☆☆



External door for unheated rooms

The choice of an internal or external door depends on the fitting situation (protected / unprotected) and on the requirements of the performance characteristics.

The classification of the individual doors shows you at a glance which functions the respective door fulfils and to what extent.

Main functions (as standard):  
 ★★★ Top   ★★ Very good   ★ Good

Additional function (with corresponding equipment):  
 ☆☆☆ Top   ☆☆ Very good   ☆ Good

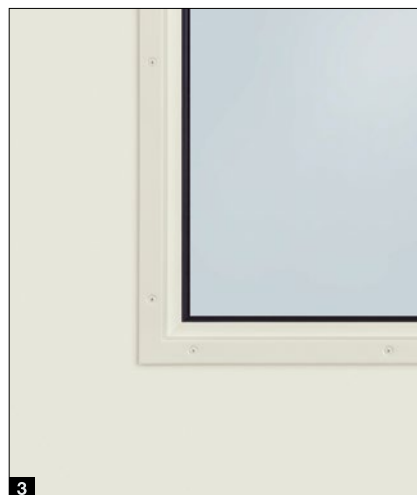
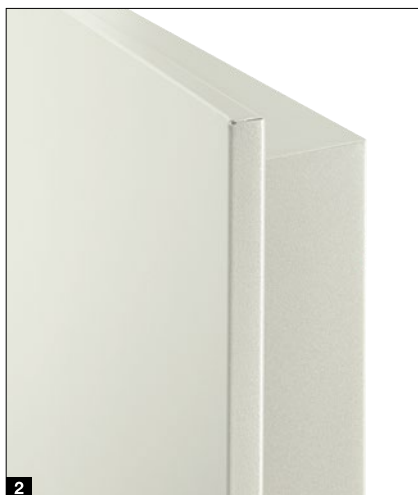



### Door leaf glued over the entire surface

The fully bonded composite construction of the door leaf ensures particularly high stability. It makes sure that the door always closes securely and accurately with a satisfying noise. The risk of door leaf warping or unevenness is virtually eliminated by the permanently flush surface.

### Rebate and door leaf on request

The fire-rated door H3 OD is supplied in the thin rebate version **1** as standard. On request, the door is also available in a thick rebate version **2** for a matching appearance with your internal doors.

### With optional glazing

The H3 OD is also available with fire-proof glass **3** on request. These doors are equipped with an additional overhead door closer.

### Self-closing function as standard

The self-closing function is realised by a stable, robust spring hinge **4** or Hörmann slide rail door closer HDC 35 **5** (depending on equipment and size). This makes every fire-rated or smoke-tight door a reassuring purchase.

### A frame for all wall types

The steel construction project door H3 OD is fitted quickly, easily and flexibly with the universal corner frame A type 2 **6** as standard. Thanks to the diagonal or anchor plate, the frame can be fitted in almost all fitting situations and wall types. The universal corner frame can be easily upgraded to a profile frame with the Vario B53 C type 1 counter frame **7**.



# Internal doors, external doors

Fire-rated door H8-5, multi-purpose door MZ

	Fire protection H8-5*	Multi-purpose MZ
Fire-retarding	★★★	—
Smoke-tightness	☆☆☆	—
Thermal insulation	★	★
Acoustic insulation	★★	★★
Break-in resistance equipment	★	★



**External door for unheated rooms**  
Multi-purpose door MZ

\*) The fire protection properties only apply to interior walls.

The classification of the individual doors shows you at a glance which functions the respective door fulfils and to what extent.

Main functions (as standard):  
★★★ Top ★★ Very good ★ Good

Additional function  
(with corresponding equipment):  
☆☆☆ Top ☆☆ Very good ★ Good



### Dual handed

The multi-purpose door MZ and the fire-rated door H8-5 are suitable for left-hand hinged door opening (hinges on the left side of the door) and right-hand hinged door opening (hinges on the right side of the door) by simply turning the door set. In addition, the bottom threshold rail is easy to remove if fitted with a continuous floor.

### Stable door set with frame

This ready-to-fit complete set is especially robust thanks to a double-skinned, 45 mm thick door leaf with thin rebate on both sides, mineral wool infill and steel reinforcement. The 2-mm-thick corner frame with all-round seal **1** reliably seals the doors. This means you can always rely on the door in terms of function and tightness. The lock and the black lever handle set **2** can be used with profile cylinders and deadlock keys. One deadlock key is provided.

### Fire-rated door H8-5

On both the door (shown on left) and the hatch **3** with 45-mm-thick door leaf and thin rebate on both sides, the fire-proof material is not exposed but is concealed on the front side across the full width and inserted flush-fitting. The door also comes with 2 steel security bolts.

### Multi-purpose door MZ

The door provides a very high level of security with 2 solid steel security bolts. The multi-purpose door MZ is also available with glazing. Due to security reasons, this glazing is kept very narrow or very small, but it still lets you benefit from daylight inside. The round glazing **4**, glazing view 5 **5** or glazing view 9 **6** is available with 7 mm wired glass as standard or with 20 mm insulated wired glass on request. The natural-finish aluminium glazing frame is fastened on the closing side with glazing beads as standard. For doors opening inwards, the glazing frame is optionally available with glazing beads on the opening side.

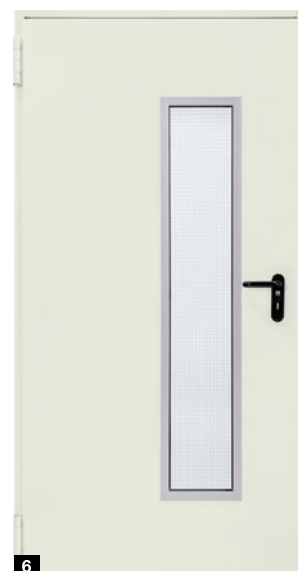
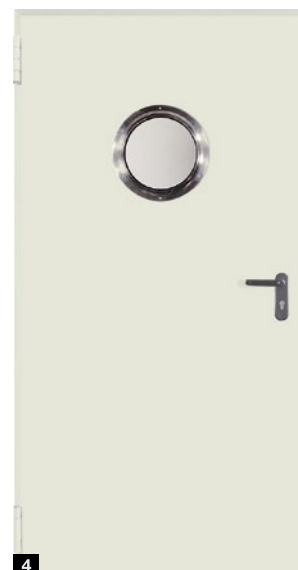

# Internal doors, external doors

Multi-purpose ZK .NEW

	Multi-purpose ZK
Fire-retarding	_____
Smoke-tightness	_____
Thermal insulation	★
Acoustic insulation	★★
Break-in resistance equipment	★

The classification of the individual doors shows you at a glance which functions the respective door fulfils and to what extent.

Main functions (as standard):  
 ★★★ Top   ★★ Very good   ★ Good

Additional function (with corresponding equipment):  
 ☆☆☆ Top   ☆☆ Very good   ☆ Good



### Complete, ready-to-fit door set

The door set provides an elegant door view with a 3-sided thick rebate **1**. Thanks to a sheet thickness of 0.8 mm, the door is also robust and dimensionally stable. It also features good thermal insulation due to fully bonded polystyrene insert with a UD-value of up to 1.6 W/(m<sup>2</sup>·K).

The door set is available with corner frame, seal on three sides, anchors and floor recess as standard. It is also equipped with a black plastic lever handle set **2**, a mortice lock with steel catch (prepared for short escutcheon) and security bolt on the hinge side. The door can be optimally adjusted with the maintenance-free hinges V0026 WF **3**.

### Colours and glazing

Choose a modern door view in RAL 7016 Anthracite grey or RAL 9010 Pure white, at the same price. In addition, two optional glazings, wired glass and clear float, provide pleasant daylight indoors.

### Use as external door

When using the multi-purpose steel door ZK as an external door, optional extras such as a retractable bottom seal, an aluminium stop profile with seal and an attachable aluminium rain canopy provide protection against wind and rain.

### Two door leaf and frame colours at the same price

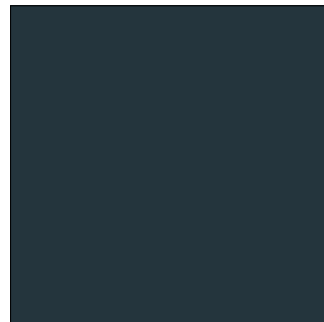

Anthracite grey RAL 7016



Pure white RAL 9010



### Optional glazing

- 4** View 5
- 5** View 6
- 6** View 7

# Internal doors

ZK and OIT 40

	ZK	OIT 40
Fire-retarding		
Smoke-tightness		
Thermal insulation		★
Acoustic insulation		☆☆
Break-in resistance equipment		☆☆

The classification of the individual doors shows you at a glance which functions the respective door fulfils and to what extent.

Main functions (as standard):  
 ★★★ Top   ★★ Very good   ★ Good

Additional function  
 (with corresponding equipment):  
 ☆☆☆ Top   ☆☆ Very good   ☆ Good



### As a door leaf or door set

The double-skinned, 40-mm-thick door leaf with a thick rebate on 3 sides and a door inlay glued over the entire surface is dimensionally stable and very robust. The door leaf is available simply for hanging or as a complete, ready-to-fit door set, including lever handle set **1** and a standard corner frame in Traffic white (similar to RAL 9016).

### Frame equipment

The frame is equipped with a seal on three sides, welded-on frame parts and anchors. The door is delivered with corner or block frame; you can also insert it into an existing standard frame or in any Hörmann steel frame.

### Smooth, quiet closing

The door has a mortice lock with lever / knob handle set **1** and is prepared for profile cylinders (backset 55 mm).

The doors close easily and quietly since they are equipped as standard with a plastic latch and steel bolt, deadlock insert and key, and on request with a profile cylinder.

### Internal door ZK

The honeycomb insert **5** makes the door dimensionally stable. As standard, you will receive the internal door ZK with a fitted lock and bright galvanized top hinge parts V 0020 **2**, firmly screwed into the reinforced sections, but without a lever handle set. Thanks to the height adjustment and individual surface design, ZK internal doors are also ideal for modernising any room from basements to lofts. They can be flexibly used in existing standard frames and all Hörmann steel frames (prepared for series V 8000 hinges).

### Double-leaf version

To provide a wider passage, the internal door ZK is also available in a double-leaf version with a flush-fitting transition between the traffic leaf and the fixed leaf **4**.

### Internal door OIT 40

The particularly robust door is available with two different door inlays, depending on your requirements:

- 6** Standard mineral wool insert with a U-value of 1.7 W/(m<sup>2</sup>·K)
- 7** (Optional) composite timber insert for improved acoustic insulation with an acoustic value R<sub>w</sub> of approx. 38 dB

You will receive the internal door OIT 40 with a fitted lock and bright galvanized top hinge parts V 0026 WF **3**, firmly screwed into the reinforced sections. The door can be optimally adjusted with maintenance-free 3-part hinges as standard. Optionally, three-way adjustable VX hinges are also available.

### Door leaf structure

- a** Door inlay
- b** Adhesive
- c** Zinc coating
- d** Steel door leaf
- e** Powder coating / foil coating

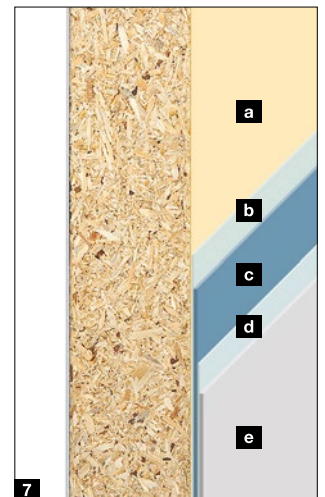
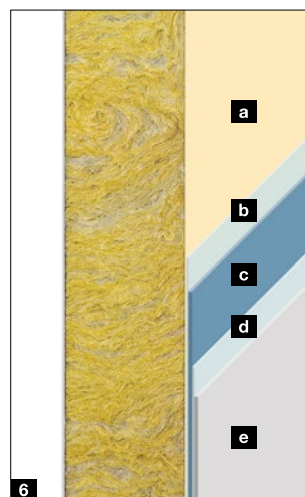
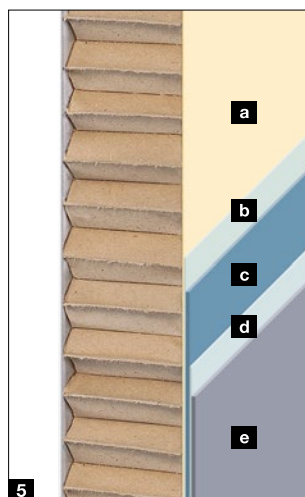
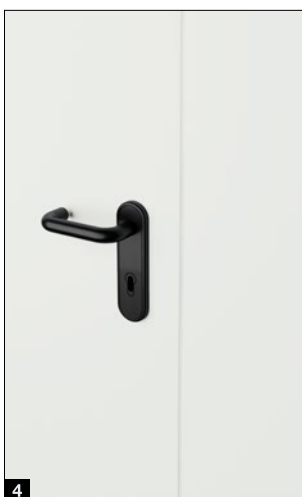

# Optional equipment

for ZK, OIT 40

## Glazing types

All ZK and OIT 40 internal doors are available with Master-Carré glazing **1** as light 7 mm wired ornamental glass, 6 mm single-pane or laminated safety glass. For on-site glazing, please note the pane thickness of 4–6 mm. Round glazing is only available from the factory.

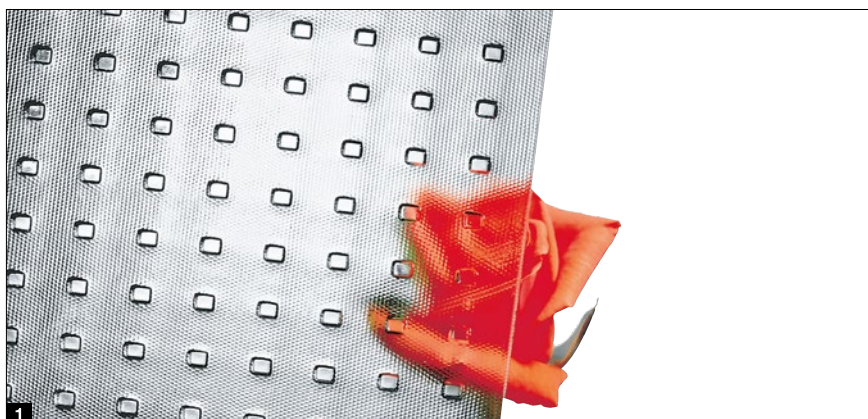

## Glazing shapes

- 2** Round glazing Ø 300 or 400 mm, brushed stainless steel
- 3** Glazing view 5, anodised aluminium in natural finish (E6 / EV1)
- 4** Glazing view 6, anodised aluminium in natural finish (E6 / EV1)
- 5** Glazing view 7, anodised aluminium in natural finish (E6 / EV1)
- 6** Glazing view 8, anodised aluminium in natural finish (E6 / EV1)
- 7** Glazing view 9, anodised aluminium in natural finish (E6 / EV1)





---

## Optional extras



Plastic ventilation grille  
(455 x 90 mm)



Wide-angle spyhole

---

## Lever handle sets

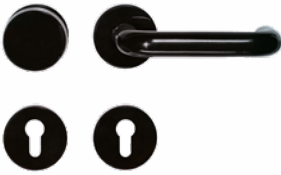

Lever / knob handle set with rose escutcheon,  
black plastic



Lever handle set with rose escutcheons  
in stainless steel



Lever / knob handle set with short escutcheon  
in anodised aluminium in natural finish

# Preferred colours

for KSI Thermo46, MZ Thermo46, MZ Thermo65, FS Thermo65, Thermo65



## MatchColor

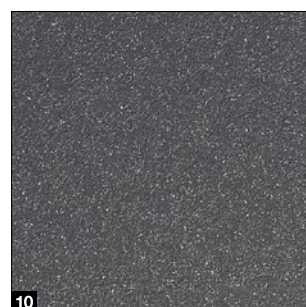
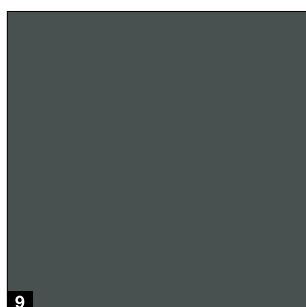
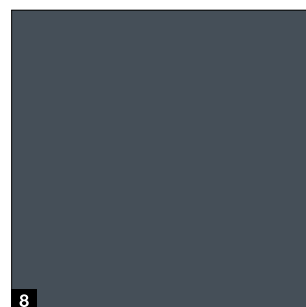
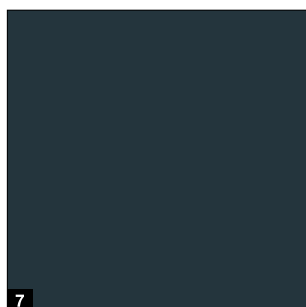
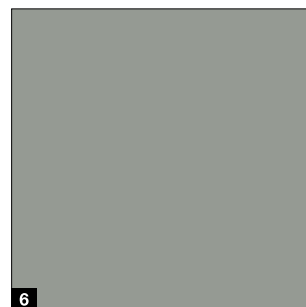
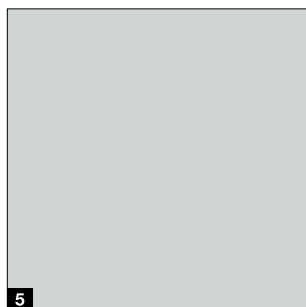
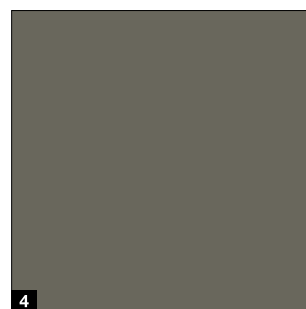
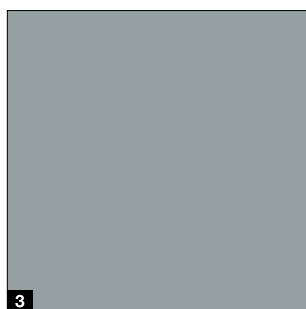
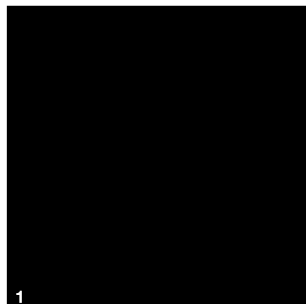

MatchColor

Design your home in perfect colour harmony – with the MatchColor preferred colours for sectional garage doors, entrance doors, side doors and steel doors with a matching appearance. Enjoy the harmonious overall appearance thanks to matching colours. That is Hörmann brand quality!

## Color

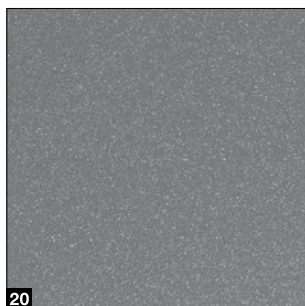
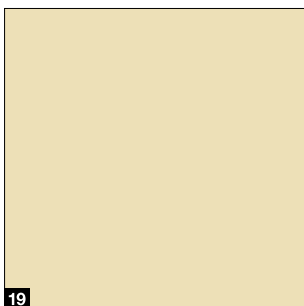
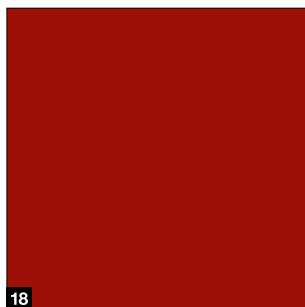
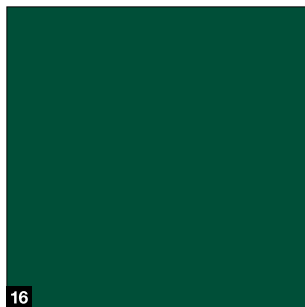
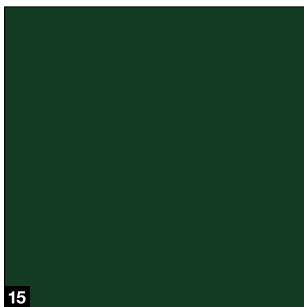
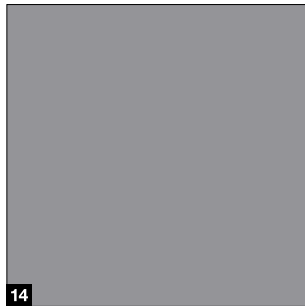
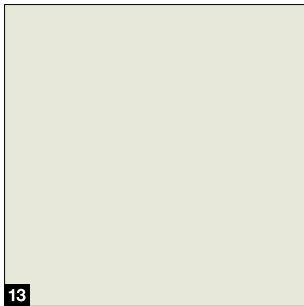
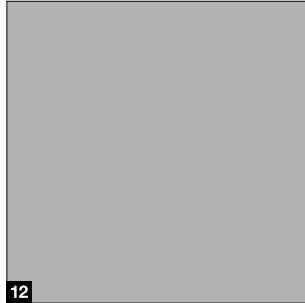
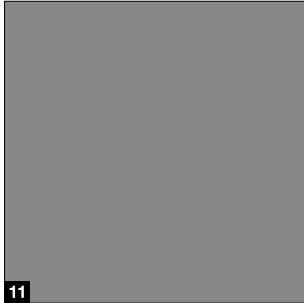

### MatchColor

- 1 RAL 9005 Jet black
- 2 RAL 8028 Terra brown
- 3 RAL 7040 Window grey
- 4 RAL 7039 Quartz grey
- 5 RAL 7035 Light grey
- 6 RAL 7030 Stone grey
- 7 RAL 7016 Anthracite grey
- 8 RAL 7015 Slate grey
- 9 RAL 7012 Basalt grey
- 10 CH 703 Anthracite metallic

### Color

- 11 RAL 9007 Grey aluminium
- 12 RAL 9006 White aluminium
- 13 RAL 9002 Grey white
- 14 RAL 7037 Dusty grey
- 15 RAL 6009 Fir green
- 16 RAL 6005 Moss green
- 17 RAL 5010 Gentian blue
- 18 RAL 3003 Ruby red
- 19 RAL 1015 Light ivory
- 20 CH 907 Grey aluminium

### Please note:

The colours and surface finishes shown are subject to the limitations of the printing process and cannot be regarded as binding. **Please consult with your local Hörmann specialised dealer.**

# Matt deluxe

for KSI Thermo46, MZ Thermo46, MZ Thermo65, FS Thermo65, Thermo65

---

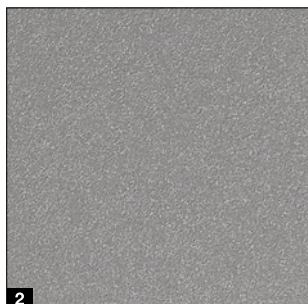
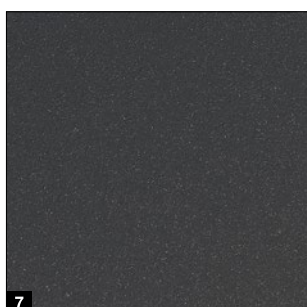
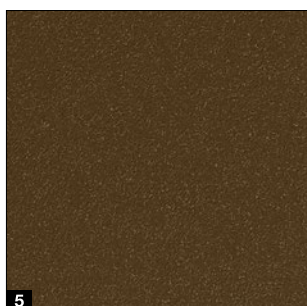
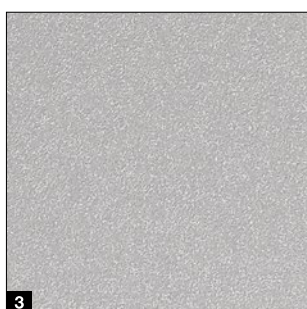
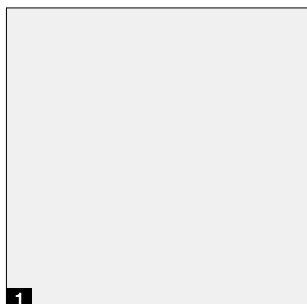

## Matt deluxe

- 1 CH 9016 Matt deluxe Traffic white
- 2 CH 9007 Matt deluxe Grey aluminium
- 3 CH 9006 Matt deluxe White aluminium
- 4 CH 9005 Matt deluxe black .NEW
- 5 CH 8028 Matt deluxe Terra brown
- 6 CH 7016 Matt deluxe Anthracite grey
- 7 CH 703 Matt deluxe Anthracite metallic

## Please note:

All colours based on RAL. The colours and surface finishes shown are subject to the limitations of the printing process and cannot be regarded as binding. **Please consult with your local Hörmann specialised dealer.**

# Preferred colours

for H3 OD

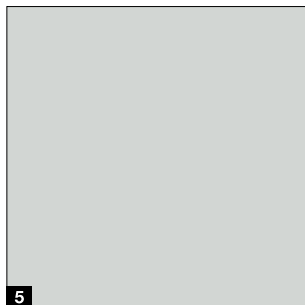
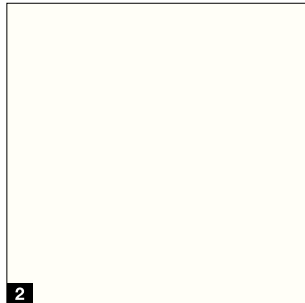
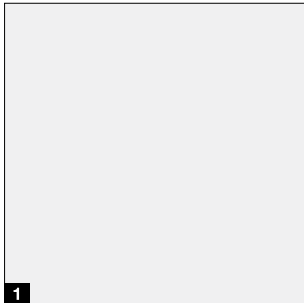

## H3 OD

- 1 RAL 9016 Traffic white
- 2 RAL 9010 Pure white
- 3 RAL 9007 Grey aluminium
- 4 RAL 9005 Jet black
- 5 RAL 7035 Light grey
- 6 RAL 7016 Anthracite grey
- 7 RAL 3003 Ruby red

## Choice of RAL colours

We also supply all doors optionally in RAL to choose and metallic colours.

### Please note:

All colours based on RAL. The colours and surface finishes shown are subject to the limitations of the printing process and cannot be regarded as binding.

**Please consult with your local Hörmann specialised dealer.**

# Preferred colours

for KSI 40, MZ, H8-5, ZK, OIT 40

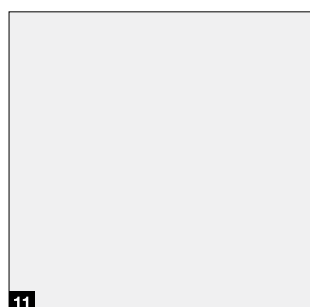
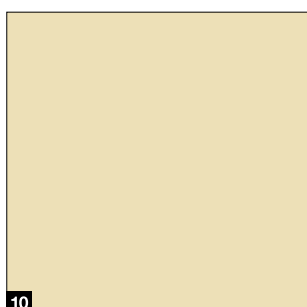
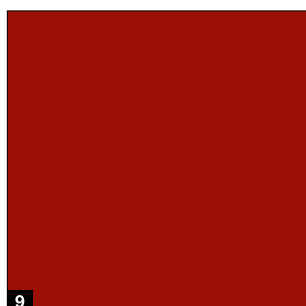
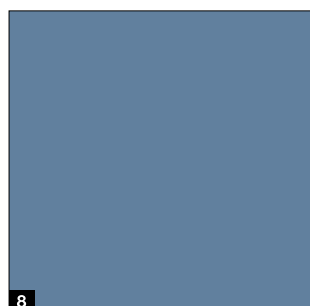
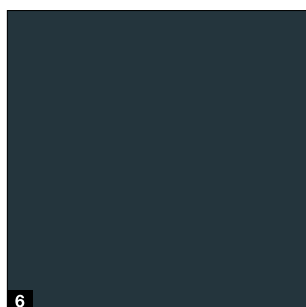
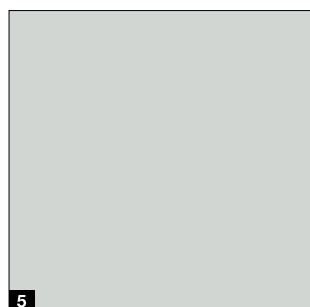
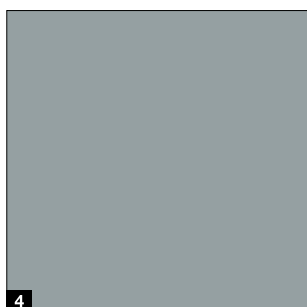
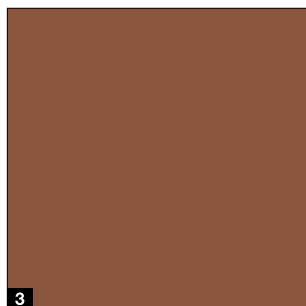
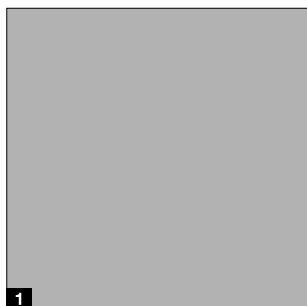

## KSI 40, ZK, OIT 40

- 1 RAL 9006 White aluminium
- 2 RAL 8028 Terra brown
- 3 RAL 8003 Clay brown
- 4 RAL 7040 Window grey
- 5 RAL 7035 Light grey
- 6 RAL 7016 Anthracite grey
- 7 RAL 6005 Moss green
- 8 RAL 5014 Pigeon blue
- 9 RAL 3003 Ruby red
- 10 RAL 1015 Light ivory

## MZ, H8-5

- 11 RAL 9016 Traffic white
- 5 RAL 7035 Light grey
- 6 RAL 7016 Anthracite grey

## Choice of RAL colours

We also supply all doors optionally in RAL to choose and metallic colours.

### Please note:

All colours based on RAL. The colours and surface finishes shown are subject to the limitations of the printing process and cannot be regarded as binding.

**Please consult with your local Hörmann specialised dealer.**

# Decograin surface finish

for KSI Thermo46, MZ Thermo46, MZ Thermo65, FS Thermo65, Thermo65, KSI 40, OIT 40

## Decors for outdoor and indoor use



### Decors for KSI Thermo46, MZ Thermo65, MZ Thermo46, FS Thermo65, Thermo65

- 1 Golden Oak, medium brown, golden yellow oak design
- 2 Dark Oak, walnut-coloured oak design
- 3 Night Oak, dark, intense oak design
- 4 Winchester Oak, natural-coloured knotty oak design
- 5 Titan Metallic CH 703, with a metallic effect

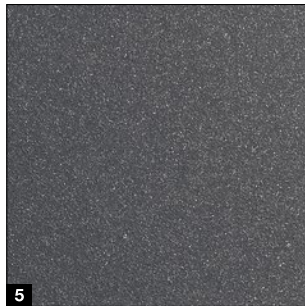

### Decors for KSI 40, OIT 40

- 1 Golden Oak, medium brown, golden yellow oak design
- 2 Dark Oak, walnut-coloured oak design
- 3 Night Oak, dark, intense oak design
- 4 Winchester Oak, natural-coloured knotty oak design
- 6 White Ash
- 7 Light Oak
- 8 Beech

## Decors for indoor use only

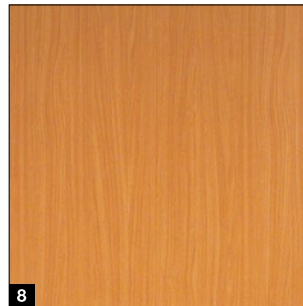
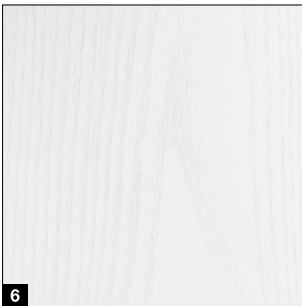

### Please note:

The colours and surface finishes shown are subject to the limitations of the printing process and cannot be regarded as binding.

**Please consult with your local Hörmann specialised dealer.**

# Size range

## Standard sizes

Door type	KSI Thermo46	FS Thermo65	Thermo65	MZ Thermo46	MZ Thermo65	KSI40-1	H3 OD	H8-5	MZ-1	Multi-purpose ZK	OIT 40
<b>Hatches</b>											
750 × 875								●			
800 × 800								●			
875 × 875								●			
875 × 1000								●			
875 × 1250								●			
<b>Single-leaf doors</b>											
625 × 2000											●
625 × 2125											●
750 × 1750								●	●		
750 × 1875						●		●	●		●
750 × 2000						●	●	●	●		●
750 × 2125						●	●				●
800 × 1800								●	●		
800 × 1875								●	●		
800 × 2000								●	●		
875 × 1750								●	●		
875 × 1800								●	●		
875 × 1875						●	●	●	●		●
875 × 2000	■	■		■	■	●	●	●	●	●	●
875 × 2125	■	■		■	■	●	●	●	●	●	●
1000 × 1875						●		●	●		●
1000 × 2000	■	■		■	■	●	●	●	●	●	●
1000 × 2100	■	■	■	■	■						
1000 × 2125	■	■		■	■	●	●	●	●	●	●
1150 × 2200	■	■	■	■	■						
1100 × 2100	■	■	■	■	■						
1125 × 2000							●				
1125 × 2125							●		●		●
1250 × 2000									●		●
1250 × 2125									●		●
<b>Double-leaf doors</b>											
1500 × 2000							●		●		●
1500 × 2125							●				●
1750 × 2000							●		●		●
1750 × 2125							●				●
2000 × 2000							●		●		●
2000 × 2125							●		●		●
2125 × 2125							●				
2250 × 2250							●				

### Ordering sizes

- = overall frame dimension
- = nominal size

Please state handing on order.



Left-hand hinged



Right-hand hinged



Traffic leaf left-hand hinged



Traffic leaf right-hand hinged

All dimensions in mm



# Sizing and fitting versions

KSI Thermo46, MZ Thermo65 / MZ Thermo46, FS Thermo65, Thermo65

## Vertical view

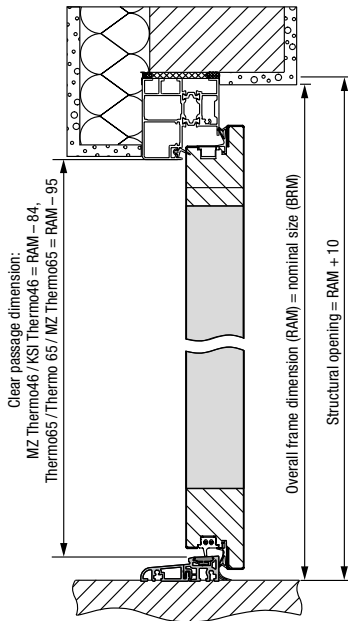

## Horizontal view

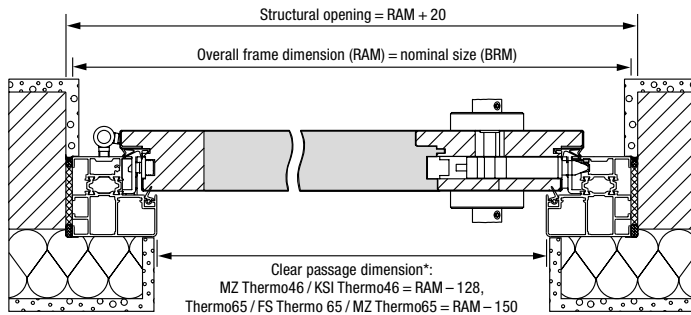

## Fitting versions

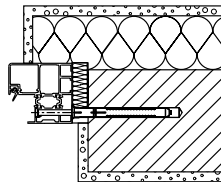

**Block frame**  
 Fitting to brickwork  
 Countersunk fitting

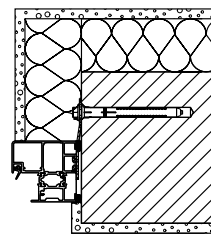

**Block frame**  
 Anchor fitting

\*) With an opening angle of  $90^\circ$  and without handles and levers, the clear passage width is reduced by 2 mm.

KSI 40

## Vertical view

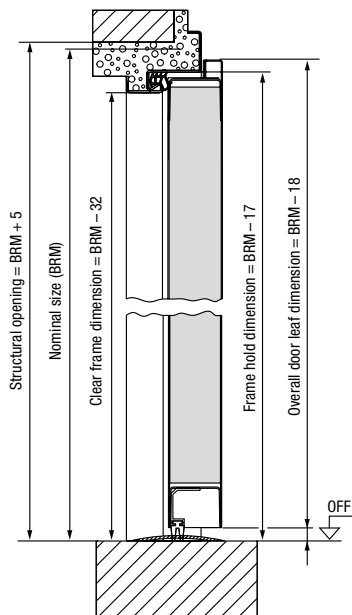

## Horizontal view

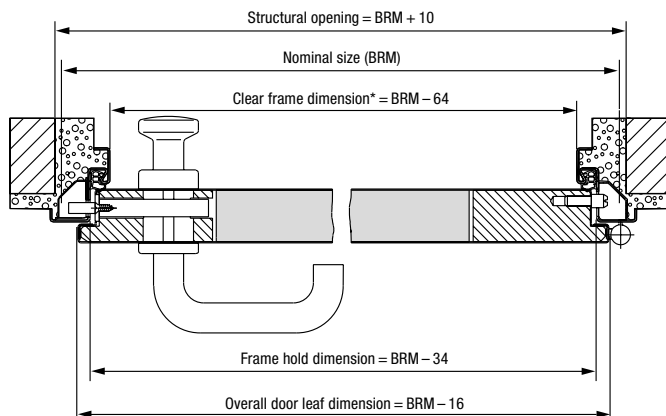

## Fitting versions

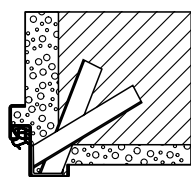

Fitting with anchor

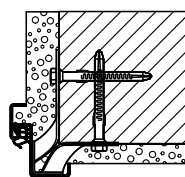

Fitting with grouting lugs

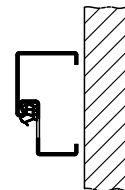

Block frame for fitting in the opening (profile 21101)

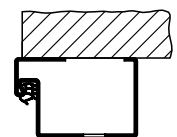

Block frame for fitting to the wall (profile 006) (tested at opposite hinge side)

\*) With an opening angle of  $90^\circ$  and without handles and levers, the clear passage width is reduced by 2 mm.

All dimensions in mm

# Sizing and fitting versions

## MZ, H8-5

### Vertical view

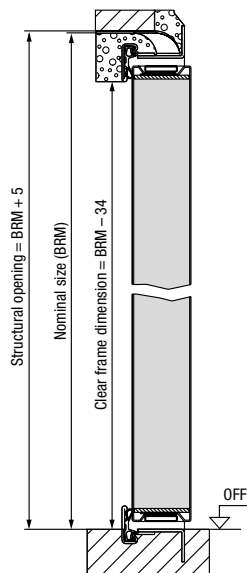

### Horizontal view

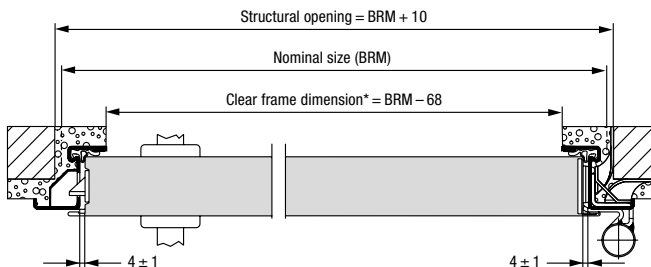

\*) With an opening angle of 90° and without handles and levers, the clear passage width is reduced by 25 mm.

### Fitting versions

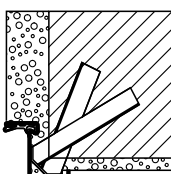

Fitting with anchor

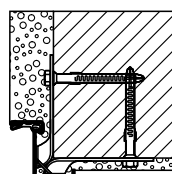

Fitting with grouting lugs

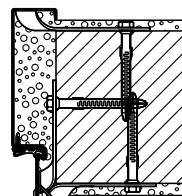

**Corner and counter frame**  
Fitting with grouting lugs

## H3 OD

### Vertical view

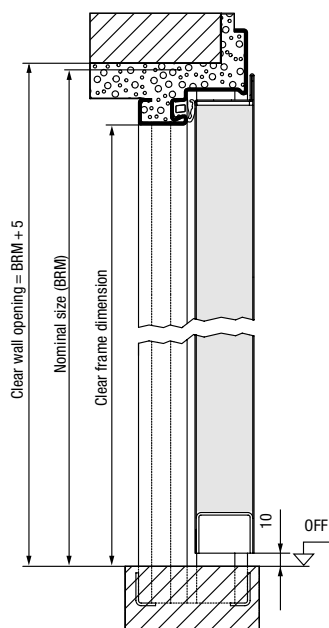

### Horizontal view

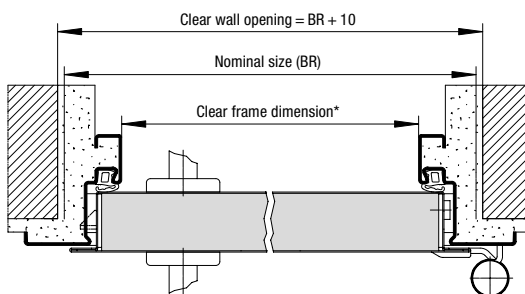

\*) With an opening angle of 90° and without handles and levers, the clear passage width is reduced by 113 mm (thin rebate) or 103 mm (thick rebate).

### Fitting versions

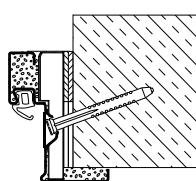

**Diagonal fixing**  
(Unplastered brickwork / concrete)

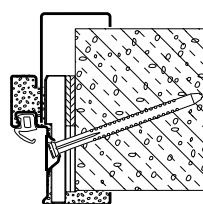

**Diagonal fixing**  
With counter frame Vario B53 as a 2-part profile frame (Gas concrete)

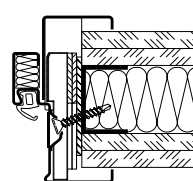

**Diagonal fixing**  
(Gas concrete)

Multi-purpose ZK, OIT 40

Vertical view

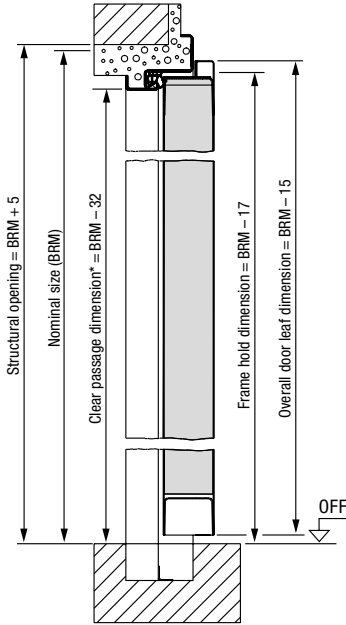

Horizontal view

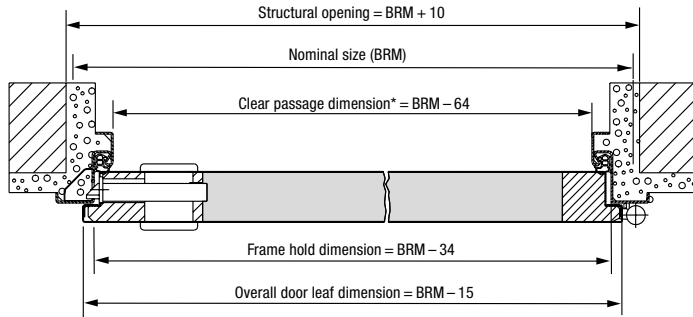

\*) With an opening angle of 90° and without handles and levers, the clear passage width is reduced by 2 mm, and by 4 mm in the case of double-leaf doors.

Fitting versions

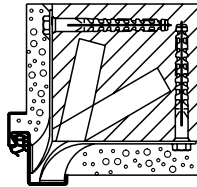

**Corner frame**  
 Fitting to brickwork  
 Anchor

# Experience Hörmann quality in new construction and modernisation

Hörmann products have impressive durability and high standards of functionality. They make it easy to plan for new construction and modernisation projects alike. The carefully coordinated solutions make your home more beautiful, more secure and more comfortable.

**GARAGE DOORS. GATE AND DOOR OPERATORS. ENTRANCE DOORS. RESIDENTIAL INTERNAL DOORS. STEEL DOORS. FRAMES. STORAGE SPACE SYSTEMS.**



Some of the products shown are equipped with special equipment and do not always correspond to the standard versions. The surface finishes and colours shown are subject to the limitations of the printing process and cannot be regarded as binding. All rights reserved. No part may be reproduced without our prior permission. Subject to changes.