



STEEL DOORS

NEW. Fire-rated and acoustic-rated doors with thermal break

HÖRMANN





4

Good reasons
to try Hörmann
sheet steel doors.



8

Application areas.

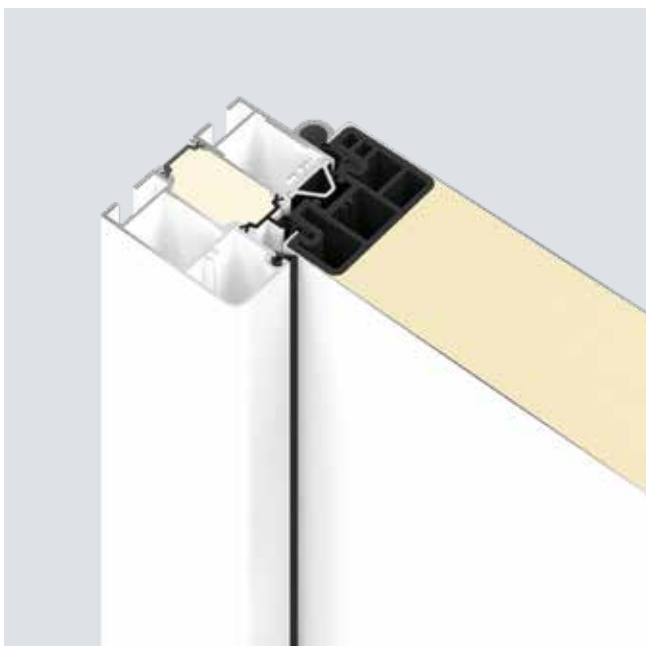

18

Versions.
Equipment.
Technology.

Responsibility for generations

The Hörmann family business has over 85 years of experience as a construction component specialist. This gives us an obligation to both current and future generations. That's why environmental responsibility plays such an important role for us. With this in mind, we develop innovative solutions for sustainable products and intelligent environmental protection.



“A GOOD REPUTATION MUST BE EARNED.”

August Hörmann

In keeping with the tradition started by the company's founder, the Hörmann brand is a true promise of quality and is one of Europe's most successful suppliers in the area of entrance doors. Due to the comprehensive international sales and service network, Hörmann is your strong partner for high-quality construction components.

AN EYE ON THE FUTURE. Hörmann is setting a good example. That's why 100% of our electricity needs in Germany come from green electricity. Together with an intelligent and certified energy management system, CO₂-neutral mailing and the recycling of valuable materials, more than 60000 tons of CO₂ are saved each year. In addition, we offset over 100000 tonnes of CO₂ by promoting wind energy and reforestation projects in cooperation with ClimatePartner.



You can find further information at
www.hoermann.de/umwelt



Brand quality made in Germany



The family-owned company Hörmann offers all important construction components for building and renovating projects from a single source. We manufacture in highly specialised factories using state-of-the-art production technologies. Our employees work intensively on new products, continual further developments and improvements to details. The results are patents and unique products on the market.





10-year warranty

LONG-LASTING. GUARANTEED. All doors are developed and manufactured by Hörmann. Endurance tests under real conditions ensure mature series products with Hörmann quality. Thanks to this and uncompromising quality assurance, you receive a 10-year* warranty on all Hörmann sheet steel doors.

* The complete warranty conditions can be found at: www.hoermann.com



Certified security features

Up to resistance class RC 4



High acoustic insulation

Up to 42 dB



Excellent thermal insulation

Up to 0.85 W/(m²·K)



T30 / EI₂30

Fire-retarding

BREAK-IN-RESISTANT RC 2 SECURITY FEATURES. Security doors KSI 40-1 / KSI Thermo46 are available with approved, break-in-resistant RC 2 security features as standard. For you, this means feeling even more secure in your own home.

UP TO 49% BETTER THERMAL INSULATION. You are looking for basement and side doors with the same thermal insulation as your entrance door? Then our security door KSI Thermo46 and multi-function doors MZ Thermo46 and MZ Thermo65 are the right choice for you: The MZ Thermo65 provides up to 49% better thermal insulation than conventional multi-purpose doors.

FIRE PROTECTION EXPERTISE. For decades, fire-rated doors have been providing optimum safety for boiler rooms, oil tank rooms or the passage between the garage and house. These doors are the best example of how you can benefit from Hörmann's expertise in fire protection.

→ For further information, see from page 20.

TITLE. Security door KSI Thermo46, Traffic white RAL 9016, and internal door ZK, Traffic white RAL 9016, with optional glazing, Fig. 7

PAGE 2 / 3. Fire-rated door H8-5, Light grey RAL 7035, and security door KSI Thermo46, Anthracite grey RAL 7016

Security door KSI Thermo46

EXTERNAL DOOR FOR BASEMENTS, HEATED OUTBUILDINGS AND GARAGES WITH ACCESS TO THE HOUSE. Thanks to the door leaf with thermal break, security door KSI Thermo46 offers the best thermal insulation and reduces the risk of condensation forming in heated rooms. The break-in-resistant RC 2 security features mean you can feel secure in your home.

→ For further information, see from page 22.





Fire-rated door FS Thermo65

**EXTERNAL DOOR FOR FIRE PROTECTION REQUIREMENTS,
E.G. FOR THE PASSAGE FROM THE GARAGE TO THE HOUSE.**

The FS Thermo65 not only withstands a fire for at least 30 minutes, but also offers up to 49% better thermal insulation thanks to a thermal break and reduces the risk of condensation forming on the door leaf in heated rooms.

→ For further information, see from page 24.

Multi-purpose doors

MZ Thermo65 / MZ Thermo46

EXTERNAL DOORS FOR BASEMENTS, HEATED OUTBUILDINGS AND GARAGES WITH ACCESS TO THE HOUSE AS WELL AS WORKSHOPS AND HOBBY ROOMS.

The MZ Thermo65 / MZ Thermo46 are more than just extremely robust. Thanks to the thermal break, they offer up to 49% better thermal insulation and reduce the risk of condensation forming in heated rooms. They are available with or without glazing as well as in a wide variety of colours and the Decograin surface finish.

→ For further information, see from page 26.





Acoustic-rated door Thermo65

EXTERNAL DOOR FOR BLOCKS OF FLATS Particularly in the case of doors for walkways, it is important to have sufficient acoustic insulation and good thermal insulation, as these doors enable access from the outside, for example, to individual flats in a residential building. The Thermo65 with acoustic rating category 3 and door leaf and frame with thermal break is ideal for this application.

→ For further information, see from page 26.



Security door KSI 40-1

EXTERNAL DOOR FOR BASEMENTS, UNHEATED OUTBUILDINGS AND FREE-STANDING GARAGES. In many cases, these areas of the house are still equipped with old doors that can be forced open in seconds. Always remember: If the basement door is open, the whole house is accessible. This is why we recommend the security door KSI 40-1 with security features as standard.

→ For further information, see from page 28.

Function door H3 OD

INTERNAL DOOR / EXTERNAL DOOR FOR FIRE PROTECTION REQUIREMENTS, E.G. FOR THE PASSAGE BETWEEN THE GARAGE AND HOUSE. Due to fire hazards in garages, a fire-rated door between the house and garage is required by law. The steel construction project door H3 OD is the best choice for this sensitive area. On request, this door can also act as a seal against smoke and engine noise and additionally protects your family from burglars with the security features.

→ For further information, see from page 30.





Fire-rated door H8-5

INTERNAL DOOR FOR FIRE PROTECTION REQUIREMENTS. The fire-rated door H8-5 is the best-selling boiler room door in Europe and for decades has been providing optimum safety for boiler rooms and rooms with oil tanks.

→ For further information, see from page 32.

Multi-purpose door MZ

INTERNAL AND EXTERNAL DOOR FOR UNHEATED OUTBUILDINGS, TOOL SHEDS AND STORAGE ROOMS. Proven for over four decades, this multi-purpose door MZ is robust, durable and weather-resistant, making it ideal for inside and outside applications. The MZ comes in a single-leaf or double-leaf design and is available with glazing on request.

→ For further information, see from page 32.





Internal door ZK

INTERNAL DOORS FOR BASEMENTS, CHILDREN'S BEDROOMS AND ACCESS TO UNRENOVATED LOFTS.

The ZK doors have proven themselves for many years as robust doors for basements and storage rooms in houses and blocks of flats as well as for access to unrenovated lofts. ZK doors do not warp and come with a high-quality surface finish that is durable, resistant to stains and easy to clean. Reliable quality at a low price.

→ For further information, see from page 34.

Internal door OIT

INTERNAL DOOR FOR OFFICES, CLASSROOMS AND WORKSHOPS.

The high-quality internal doors OIT 40 are particularly robust, dimensionally stable and durable. They are recommended for tough everyday use in industrial and commercial buildings, workshops, administrative buildings, schools and barracks. Thanks to the different infill variants, they also fulfil the special requirements for acoustic insulation and thermal insulation.

→ For further information, see from page 34.





22

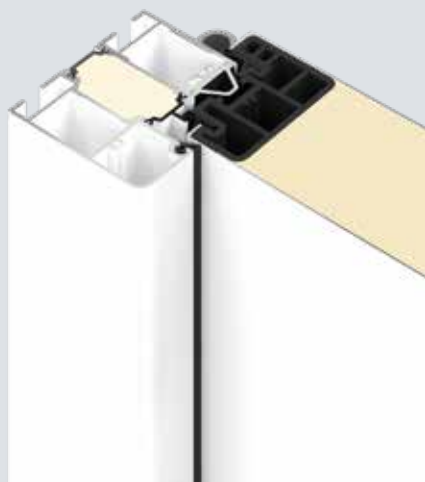

36



43

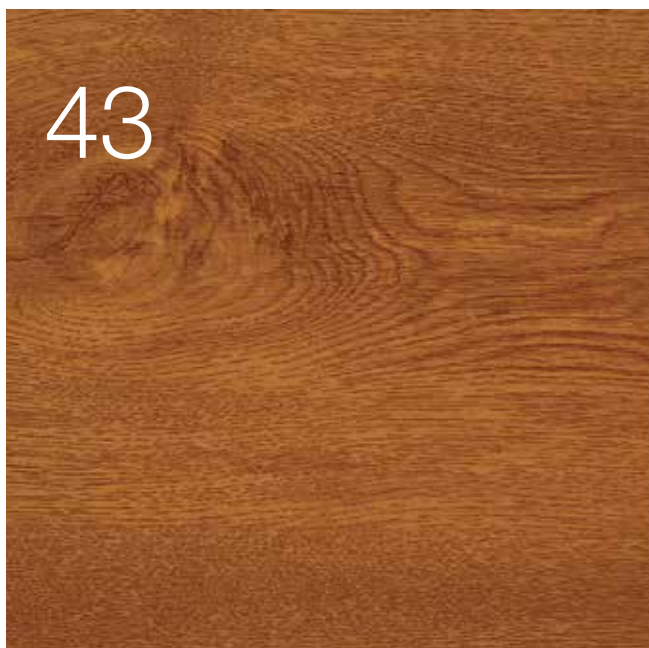









Versions. Equipment. Technology.

- 20 Door overview
- 22 External doors with thermal break
- 28 External doors
- 30 Internal doors, external doors
- 30 Internal doors
- 36 Optional equipment
- 38 Preferred colours / Matt deluxe
- 43 Decograin surface finish
- 44 Size range
- 45 Door sizing and fitting variants

Door overview

Functions, performance characteristics, size ranges

Door type	KSI Thermo46	FS Thermo65 .NEW	MZ Thermo65	MZ Thermo46
Internal door				
 External door for unheated buildings				
 External door for heated buildings	■	■	■	■
Version	Single-leaf	Single-leaf	Single-leaf	Single-leaf
 T30 Fire-retarding				
 EI230 fire-retarding		★★★		
 S₂₀₀ Smoke-tight		★★★		
 Thermally insulated	★★	★★★★	★★★★	★★
 Acoustic-rated	★	★★		★★
 S_a Sealed		★★★		
 Break-in-resistant	★★		★	★
Door set				
Door leaf thickness	46 mm	65 mm	65 mm	65 mm
Sheet thickness	0.6 – 0.8 mm	0.6 – 0.8 mm	0.6 – 0.8 mm	0.6 – 0.8 mm
Rebate type	Thick rebate	Thick rebate	Thick rebate	Thick rebate
Door leaf and frame with thermal break	●	●	●	●
Performance characteristics				
Resistance class	RC2			
Thermal insulation	1.1 W/(m²·K)	0.85 W/(m²·K)	0.87 – 1.0 W/(m²·K)	1.1 – 1.6 W/(m²·K)
Acoustic insulation	Up to 29 dB	Up to 32 dB		Up to 32 dB
Self-closing		C5		
Water tightness under heavy rain – opening inwards		3 A		
Resistance to wind load		C3 / B3		
Air permeability		Class 2		
Differential climate behaviour		3 (c), 2 (d), 2 (e)		
Climatic class				
Duty category				
Fitting in				
Brickwork	≥ 115 mm	≥ 175 mm	●	●
Concrete	≥ 100 mm	≥ 175 mm	●	●
Gas concrete			●	●
Size range				
Nominal size width	832 – 1250 mm	850 – 1250 mm	700 – 1250 mm	700 – 1250 mm
Nominal size height	1875 – 2250 mm	1750 – 2250 mm	1750 – 2250 mm	1750 – 2250 mm

Main functions (standard): ★★★ Best value ★★ Excellent value ★ Good value

Secondary function (with corresponding equipment): ★★★ Best value ★★ Excellent value ★ Good value

Thermo65
acoustic
insulation
.NEW

KSI 40-1

H3 OD

H8-5

MZ-1

ZK

OIT

		■	■	■	■	■
	■	■		■		
■						
Single-leaf	Single-leaf	Single-leaf	Single-leaf / hatch	Single-leaf / double-leaf	Single-leaf / double-leaf	Single-leaf / double-leaf
		★★★★	★★★★			
		☆☆☆	☆☆☆			
★★★★	★	★	★	★		★
☆☆☆☆		☆☆☆☆	★★	★★		☆☆
☆☆	★★	☆☆☆	★	★		☆☆
65 mm	40 mm	65 mm	45 mm	45 mm	40 mm	40 mm
0.6 – 0.8 mm	0.8 mm	1.0 / 1.5 mm	0.9 mm	0.9 mm	0.6 mm	0.8 mm
Thick rebate	Thick rebate	Thin / thick rebate	Thin rebate	Thin rebate	Thick rebate	Thick rebate
●						
RC 2 (optional)	RC2	RC 4 (optional)				RC 2 (optional)
0.87 W/(m²·K)	1.7 W/(m²·K)	1.5 – 1.7 W/(m²·K)	1.7 W/(m²·K)	1.7 W/(m²·K)	2.1 W/(m²·K)	1.7 W/(m²·K)
Up to 42 dB		32 – 43 dB	Up to 39 dB	Up to 39 dB		Up to 38 dB
3 A						
Class 4						
2 (d), 2 (e)						
	III				III	III
	S				S	S
●	≥ 115 mm	≥ 115 mm	≥ 115 mm	●	●	●
●	≥ 100 mm	≥ 100 mm	≥ 100 mm	●	●	●
●		≥ 150 mm		●	●	●
700 – 1250 mm	625 – 1250 mm	500 – 1500 mm	625 – 1000 mm	625 – 1250 mm	625 – 1250 mm	625 – 1250 mm
1750 – 2250 mm	1700 – 2250 mm	500 – 2500 mm	800 – 2125 mm	1570 – 2134 mm	2000 – 2125 mm	2000 – 2125 mm

External doors with thermal break

Security door KSI Thermo46

	KSI Thermo46
Fire-retarding	
Smoke-tightness	
Thermal insulation	★★
Acoustic insulation	★
break-in resistance equipment	★★

30% better thermal insulation
compared to a conventional security door

External door for heated rooms

The classification of the individual doors shows you at a glance which functions the respective door fulfils and to what extent.

Main functions (as standard):
★★★ Best value ★★ Excellent value
★ Good value

Secondary function (with corresponding equipment): ★★★★★ Best value
★★★★ Excellent value ★★ Good value

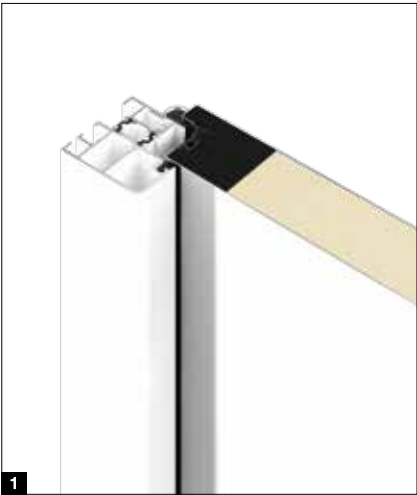

The same thermal insulation as with entrance doors

These days, saving energy is important throughout the entire home. The door leaf, frame and threshold all come with a thermal break and prevent the risk of condensation forming in heated rooms. Thanks to a 46 mm thick door leaf **1** with PU rigid foam infill and double seals on all four sides, the KSI Thermo46 has a thermal insulation value usually only found in entrance doors.

Well equipped in terms of security

Basement and side doors are often weak points when it comes to security. In this respect, the KSI Thermo46 offers the best equipment as well: 1 lock bolt **2** and 2 conical swing bolts engage with 2 additional security bolts **3** in the frame's lock plate and firmly pull the door shut. 3 additional security bolts **4** and 3 guide rollers **5** on the hinge side make it practically impossible to force the door open.



RC2 security
Tested and certified

The opportunist burglar attempts to break open the locked door with simple tools within 3 minutes.



External doors with thermal break

Fire-rated door FS Thermo65

	FS Thermo65
Fire-retarding	★★★★
Smoke-tightness	★★★★
Thermal insulation	★★★★
Acoustic insulation	★★
break-in resistance equipment	

49% better
thermal insulation

compared to a conventional
fire-rated door

External door for
heated rooms

The classification of the individual doors shows you at a glance which functions the respective door fulfils and to what extent.

Main functions (as standard):
★★★★ Best value ★★ Excellent value
★ Good value

Secondary function (with corresponding equipment): ★☆☆ Best value
★★ Excellent value ★ Good value



Fire-rated door FS Thermo65 .NEW

The 65 mm thick door leaf **1** without glazing has a particularly high U_D -value of up to $0.85 \text{ W}/(\text{m}^2 \cdot \text{K})$ and first class thermal insulation. The fire-rated door withstands a fire for at least 30 minutes, making it the right solution for the passage between the garage and your living space (e.g. entrance hall).

High thermal insulation

The door leaf of the fire-rated door FS Thermo65 is filled with mineral wool, the frame and threshold have a thermal break. This and the all-round double seals on all four sides make sure the door is optimally sealed and provides high thermal insulation.

High-quality equipment

For the self-closing function, the fire-rated door FS Thermo65 is equipped with the Hörmann slide rail door closer HDC 35 **2** as standard. The doors can be optimally adjusted using the three-way adjustable guide rollers **3**.

The fire-rated doors FS Thermo65 are available in 3 styles each with 1-point lock or multiple-point locking.

Styles with black lever handle set and 1-point lock

4 FSTHP 011

6 FSTHP 016

8 FSTHP 516

Styles with stainless steel handle HB 14-2 or HB 38-2 (optional) or lever handle set and multiple-point locking

5 FSTHP 010 (shown with stainless steel handle HB 14-2)

7 FSTHP 015 (shown with stainless steel handle HB 14-2)

9 FSTHP 515 (shown with stainless steel handle HB 14-2)



External doors with thermal break

Multi-purpose doors MZ Thermo65 / MZ Thermo46, acoustic-rated door Thermo65

	MZ Thermo65	MZ Thermo46	Thermo65 Acoustic insulation
Fire-retarding			
Smoke-tightness			
Thermal insulation	★★★	★★	★★★
Acoustic insulation		★★	☆☆☆
break-in resistance equipment	★	★	☆☆



49% better thermal insulation
MZ Thermo65 compared to a conventional multi-purpose door



External door for heated rooms

The classification of the individual doors shows you at a glance which functions the respective door fulfils and to what extent.

Main functions (as standard):
★★★ Best value ★★ Excellent value ★ Good value

Secondary function (with corresponding equipment):
☆☆☆ Best value ☆☆ Excellent value ☆ Good value

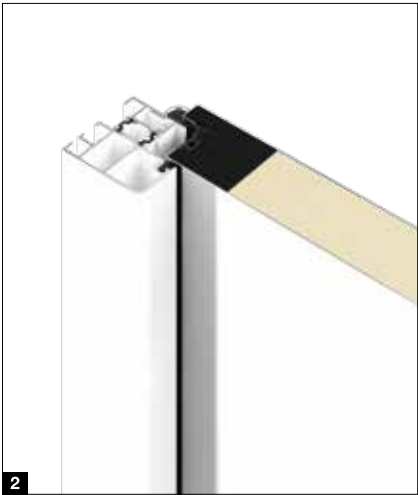

High thermal insulation

How to sustainably reduce your heat losses. The door leaf, frame and threshold all come with a thermal break and prevent the risk of condensation forming in heated rooms. This and the all-round double seals on all four sides make sure the doors are optimally sealed and provide high thermal insulation.

Stability and functionality

The doors are exceptionally stable and robust thanks to the solid door leaf. The doors can be optimally adjusted using the three-way adjustable guide rollers **3**.

Multi-purpose doors MZ Thermo65 / MZ Thermo46

The 65 mm thick door leaf **1** of the MZ Thermo65 has a particularly high UD-value of up to 0.87 W/(m²·K) and up to 49% better thermal insulation compared to a conventional multi-purpose door. The MZ Thermo46 with its 46 mm thick door leaf **2** has a thermal insulation value of up to 1.1 W/(m²·K).

To allow you to let the daylight into your workshop or hobby room, for example, the MZ Thermo65 / MZ Thermo46 is available not only with the solid styles THP 011 / TPS 011 (shown left) but also with the glazed styles TPS 021S / THP 021S **4** with round style frame **5** and Satinato glazing, THP 051S / TPS 051S **6** with profile style frame **7** and Satinato glazing or TPS 051F / THP 051F **6** with clear glass.

Acoustic-rated door Thermo65 .NEW

Acoustic-rated door Thermo65 **8** with 65 mm thick door leaf and stainless steel handle HB 14-2 has a particularly good UD-value of up to 0.95 W/(m²·K) and first class acoustic insulation. With the standard threshold the doors achieve acoustic rating category 3 (42 dB) and acoustic rating category 2 (37 dB) with the optional retractable bottom seal. They provide protection against street noise as well as wind and weather: the ideal door for entrances in blocks of flats with arcades.



External doors

Security door KSI 40

KSI 40

Fire-retarding	
Smoke-tightness	
Thermal insulation	★
Acoustic insulation	
break-in resistance equipment	★★



External door for unheated rooms

The classification of the individual doors shows you at a glance which functions the respective door fulfils and to what extent.

Main functions (as standard):
★★★★ Best value ★★ Excellent value
★ Good value

Secondary function (with corresponding equipment): ★★★★★ Best value
★★★★ Excellent value ★ Good value



Sturdy door leaf

The KSI 40-1 features a double-skinned, 40 mm thick door leaf with 3-sided thick rebate and sheet steel on both sides (0.8 mm). The stability of the door leaf is a result of the all-round reinforcement frame and the mineral wool insert which is glued over the entire surface. A 3-sided EPDM seal **1** and double lip seal (incl. aluminium semi-circular threshold as a bottom edge) seal the door reliably. This means you can always rely on the door in terms of function and tightness. Hörmann offers this door as a complete door set with frame.

High security

The standard security of the KSI 40-1 lets you and your family sleep peacefully, as it comes with pull-off protection and a drill-resistant security lever / knob handle set **2** as well as lock bolt **3**. The solid steel bolts on the hinge side **4** make it almost impossible to force the door open. The door is equipped with a 3-part hinge **5** as standard. A three-way adjustable VX hinge **6** is optionally available. The KSI 40-1 has been tested in accordance with European standard DIN EN 1627 on the opening and closing side and has resistance class 2.



RC2 security
Tested and certified

The opportunist burglar attempts to break open the locked door with simple tools within 3 minutes.



Internal doors, external doors

Function door H3 OD

	Multi- function H3 OD
Fire-retarding	★★★
Smoke-tightness	☆☆☆
Thermal insulation	★
Acoustic insulation	☆☆☆
break-in resistance equipment	☆☆☆



External door for unheated rooms

The choice of an internal or external door depends on the fitting situation (protected / unprotected) and on the requirements regarding the performance characteristics.

The classification of the individual doors shows you at a glance which functions the respective door fulfils and to what extent.

Main functions (as standard):
★★★ Best value ★★ Excellent value
★ Good value

Secondary function (with corresponding equipment): ☆☆☆ Best value
☆☆ Excellent value ☆ Good value



Fully bonded door leaf

The fully bonded composite construction of the door leaf ensures particularly high stability. This way, the door always closes securely and accurately with a satisfying noise. The risk of door leaf warping or unevenness is virtually eliminated by the permanently flush surface.

Rebate and door leaf on request

Fire-rated door H3 OD is available with thin rebate **1** as standard. The door is also available with thick rebate **2** to match your internal doors.

With optional glazing

On request, the H3 OD is available with clear fire-proof glass **3** for more light. These doors are equipped with an additional overhead door closer.

Self-closing function as standard

The self-closing function is realised by a stable, robust spring hinge **4** or Hörmann slide rail door closer HDC 35 **5** (depending on equipment and size). This makes every fire-rated or smoke-tight door a reassuring purchase.

A frame for all wall types

The steel construction project door H3 OD is fitted quickly, easily and flexibly with the universal corner frame A type 2 **6** as standard. Thanks to the diagonal or anchor fitting, the frame can be fitted in almost all fitting situations and wall types. The universal corner frame can be easily upgraded to a profile frame with the counter frame Vario B53 C type 1 **7**.



Internal doors, external doors

Fire-rated door H8-5, multi-purpose door MZ

	Fire protection H8-5*	Multi-purpose MZ
Fire-retarding	★★★	
Smoke-tightness	☆☆☆	
Thermal insulation	★	★
Acoustic insulation	★★	★★
break-in resistance equipment	★	★



External door for
unheated rooms
Multi-purpose door MZ

* The fire protection characteristics
only apply to internal walls.

The classification of the individual doors
shows you at a glance which functions
the respective door fulfils and to what
extent.

Main functions (as standard):
★★★ Best value ★★ Excellent value
★ Good value

Secondary function (with corresponding
equipment): ☆☆☆ Best value
☆☆ Excellent value ☆ Good value



Dual handed

Multi-purpose door MZ and fire-rated door H8-5 can be actuated for left-hand hinged (hinges on the left side of the door) and right-hand hinged (hinges on the right side of the door) door opening by simply turning the door set. Additionally, the bottom threshold rail is easy to remove if fitted with a continuous floor.

Sturdy door set with frame

The ready-to-fit complete door set with double-skinned 45 mm thick door leaf, 2-sided thin rebate, mineral wool infill and steel reinforcement is particularly robust. The 2 mm thick croner frame with all-round seal **1** reliably seals the doors. This means you can always rely on the door in terms of function and tightness. The lock and black lever handle set **2** can be used with profile cylinders and deadlock keys. One deadlock key is provided.

Fire-rated door H8-5

On both the door (shown on left) and the hatch **3** with 45 mm thick door leaf and 2-sided thin rebate, the fire-proof material is not exposed but is concealed on the front side across the full width and is flush-fitting. Additionally, the door is equipped with 2 steel security bolts.

Multi-purpose door MZ

The door provides a high level of security with 2 solid steel security bolts. Multi-purpose door MZ is also available with glazing. Due to security reasons, this glazing is kept very narrow or very small, but it still lets you benefit from daylight inside. Round glazing **4**, the glazing in Fig. 5 **5** and in Fig. 9 **6** is available with 7 mm wired glass as standard, and with 20 mm insulated wired glass on request. The natural-finish aluminium glazing frame is fastened on the closing side with glazing beads as standard. For doors opening inwards, the glazing frame is optionally available with glazing beads on the opening side.



Internal doors

ZK and OIT

	ZK	OIT
Fire-retarding		
Smoke-tightness		
Thermal insulation		★
Acoustic insulation		☆☆
break-in resistance equipment		☆☆

The classification of the individual doors shows you at a glance which functions the respective door fulfils and to what extent.

Main functions (as standard):
★★★★ Best value ★★ Excellent value
★ Good value

Secondary function (with corresponding equipment): ☆☆☆ Best value
☆☆ Excellent value ☆ Good value



As a door leaf or door set

The double-skinned, 40 mm thick door leaf with a thick rebate on 3 sides and fully bonded door inlay is dimensionally stable and robust. The door leaf is available as a ready-to-hang version or as a complete ready-to-fit door set including lever handle set **1** and a corner frame in Traffic white (similar to RAL 9016) as standard.

Frame equipment

The frame is equipped with a seal on 3 sides, welded frame parts and through plugs. The door is available with corner or block frame; you can also insert it into an existing standard frame and in every Hörmann steel frame.

Smooth, quiet closing

The door has a mortice lock with lever / knob **1** acc. to DIN 18251 class 3 and is prepared for profile cylinders (backset 55 mm). The doors close smoothly and quietly and are equipped with a plastic latch and steel bolt, deadlock insert and key as standard, and with a profile cylinder on request.

Internal door ZK

The door is dimensionally stable thanks to the honeycomb insert **4**. As standard, internal door ZK is available with a fitted lock and bright galvanized top hinge parts V 0020 **2**, firmly screwed into the reinforced sections, but without a lever handle set. Thanks to the height adjustment and individual surface finish design, internal doors ZK are also ideal for modernising any room from the basement to the roof. They can be flexibly used in existing standard frames and all Hörmann steel frames (prepared for series V 8000 hinges).

Internal door OIT

Depending on the requirement, this particularly robust door is available in two different door inlays:

5 Standard mineral wool inlay with a U-value of 1.7 W/(m²·K)

6 Composite timber insert (optional) for improved acoustic insulation with acoustic insulation value R_w of approx. 38 dB

Internal door OIT is delivered with fitted lock and bright-galvanized top hinge parts V 0026 WF **3** firmly screwed into the reinforced sections. The door can be optimally adjusted with maintenance-free 3-part hinges as standard. Optionally, you can obtain three-way adjustable VX hinges.

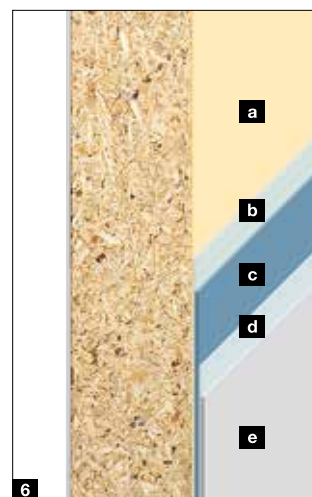
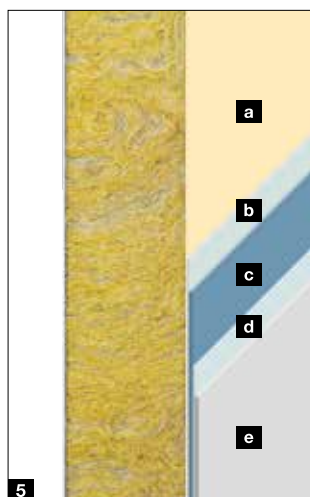
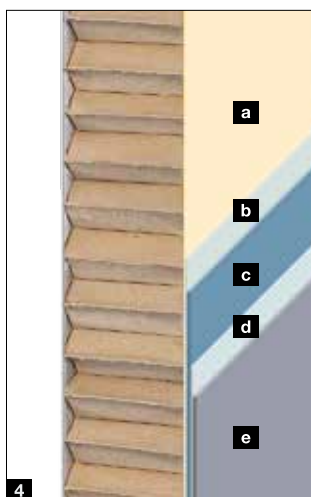

- a** Door inlay
- b** Adhesive
- c** Zinc coating
- d** Steel door leaf
- e** Powder coating / foil coating

Optional equipment

for ZK, OIT

Glazing types

All internal doors ZK and OIT 40 are available on request with Master-Carré glazing **1** with light 7 mm wired ornamental glass, 6 mm single-pane or laminated safety glass. If glazing is to be fitted on site, please note the pane thickness of 4 – 6 mm. Round glazing is only available from the factory.

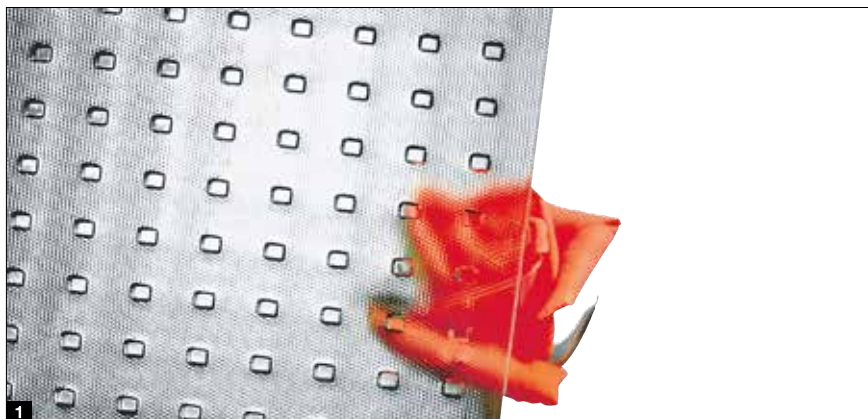

Glazing shapes

- 2** Round glazing Ø 300 or 400 mm, brushed stainless steel
- 3** Glazing Fig. 5, anodised aluminium in natural finish (E6 / EV1)
- 4** Glazing Fig. 6, anodised aluminium in natural finish (E6 / EV1)
- 5** Glazing Fig. 7, anodised aluminium in natural finish (E6 / EV1)
- 6** Glazing Fig. 8, anodised aluminium in natural finish (E6 / EV1)
- 7** Glazing Fig. 9, anodised aluminium in natural finish (E6 / EV1)



Optional extras



Plastic ventilation grille
(455 x 90 mm)



Wide-angle spyhole

Lever handle sets



Lever / knob handle set with rose escutcheon,
black plastic



Lever handle set with rose escutcheons
in stainless steel



Lever / knob handle set with short escutcheon
in anodised aluminium in natural finish

Preferred colours

for KSI Thermo46, MZ Thermo46, MZ Thermo65, FS Thermo65, Thermo65

MatchColor .NEW



MatchColor

Design your home in perfect colour harmony – with the MatchColor preferred colours for sectional garage doors, entrance doors, side doors and sheet steel doors with a matching appearance. Enjoy the harmonious overall appearance thanks to matching colours. That is Hörmann brand quality!

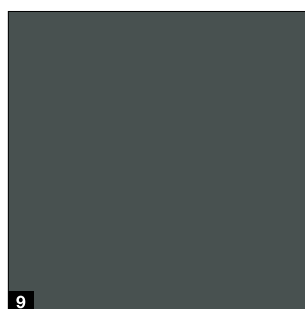
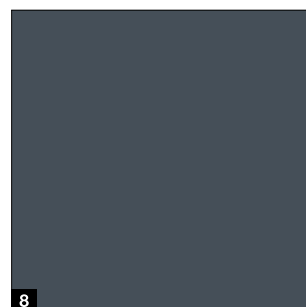
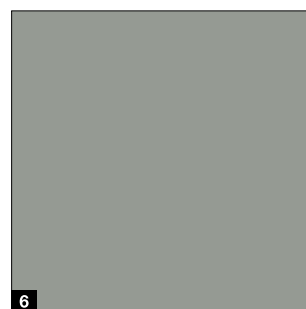
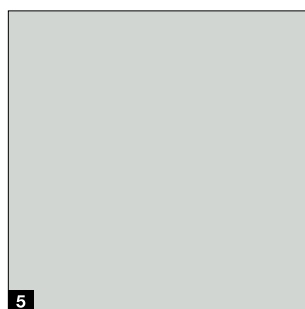
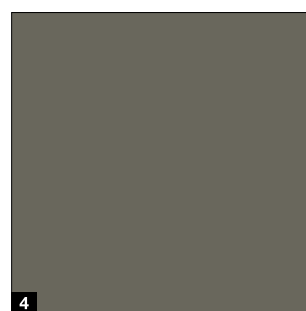
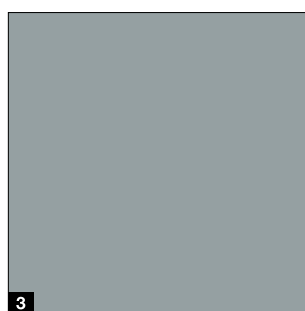
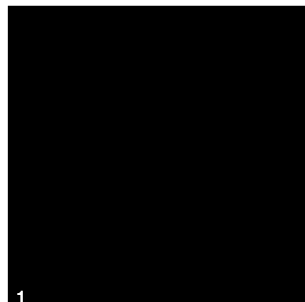

Color

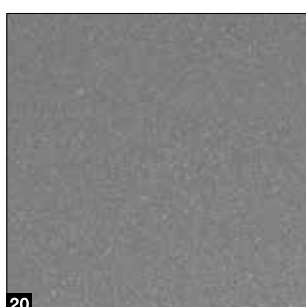
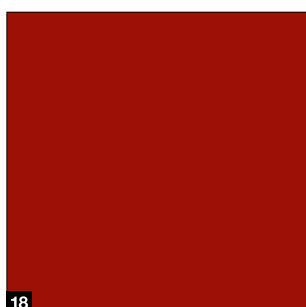
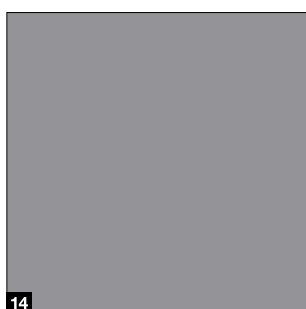
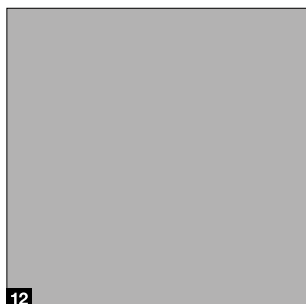
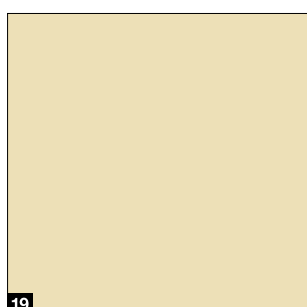
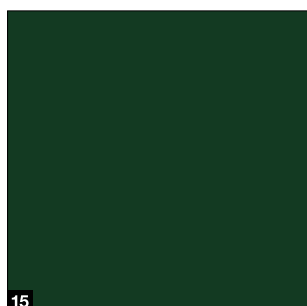
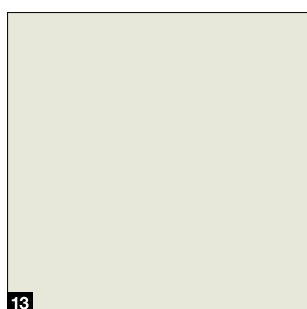
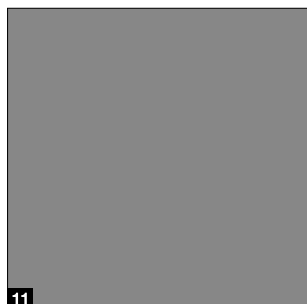

MatchColor .NEW

- 1** RAL 9005 Jet black
- 2** RAL 8028 Terra brown
- 3** RAL 7040 Window grey
- 4** RAL 7039 Quartz grey
- 5** RAL 7035 Light grey
- 6** RAL 7030 Stone grey
- 7** RAL 7016 Anthracite grey
- 8** RAL 7015 Slate grey
- 9** RAL 7012 Basalt grey
- 10** CH 703 Anthracite metallic

Color

- 11** RAL 9007 Grey aluminium
- 12** RAL 9006 White aluminium
- 13** RAL 9002 Grey white
- 14** RAL 7037 Dusty grey
- 15** RAL 6009 Fir green
- 16** RAL 6005 Moss green
- 17** RAL 5010 Gentian blue
- 18** RAL 3003 Ruby red
- 19** RAL 1015 Light ivory
- 20** CH 907 Grey aluminium

Please note:

The colours and surface finishes shown are subject to the limitations of the printing process and cannot be regarded as binding.

Please consult with your local Hörmann specialised dealer.

Matt deluxe

for KSI Thermo46, MZ Thermo46, MZ Thermo65, FS Thermo65, Thermo65

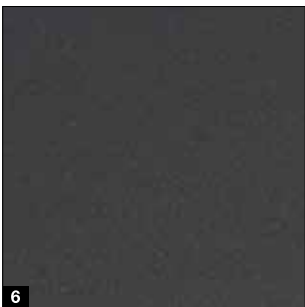
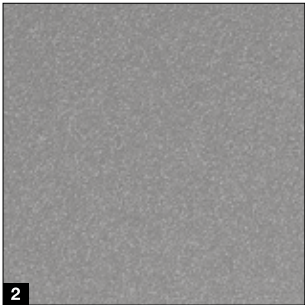
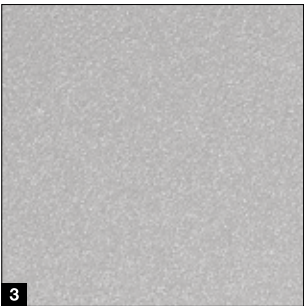
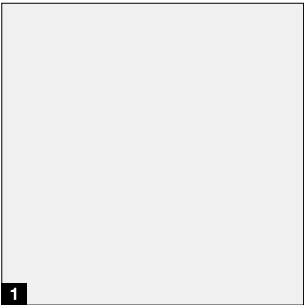

Matt deluxe

- 1 CH 9016 Matt deluxe Traffic white
- 2 CH 9007 Matt deluxe Grey aluminium
- 3 CH 9006 Matt deluxe White aluminium
- 4 CH 8028 Matt deluxe Terra brown
- 5 CH 7016 Matt deluxe Anthracite grey
- 6 CH 703 Matt deluxe Anthracite metallic

Please note:

All colours based on RAL. The colours and surface finishes shown are subject to the limitations of the printing process and cannot be regarded as binding. **Please consult with your local Hörmann specialised dealer.**

Preferred colours

for H3 OD

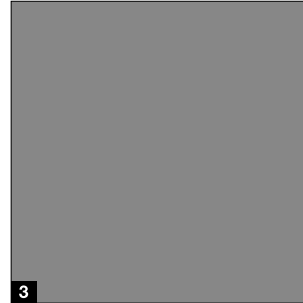
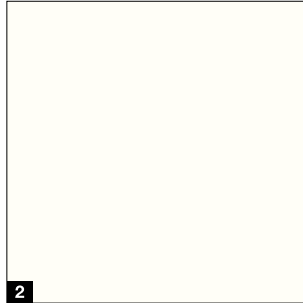
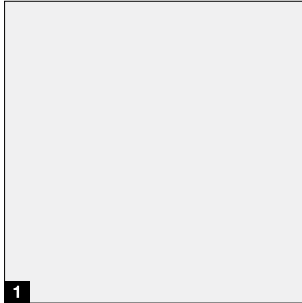

H3 OD

- 1** RAL 9016 Traffic white
- 2** RAL 9010 Pure white
- 3** RAL 9007 Grey aluminium
- 4** RAL 9005 Jet black
- 5** RAL 7035 Light grey
- 6** RAL 7016 Anthracite grey
- 7** RAL 3003 Ruby red

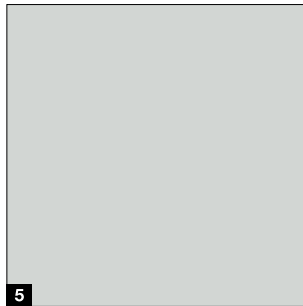

RAL to choose

We optionally also supply all doors in RAL to choose and metallic colours.

Please note:

All colours based on RAL. The colours and surface finishes shown are subject to the limitations of the printing process and cannot be regarded as binding. **Please consult with your local Hörmann specialised dealer.**



Preferred colours

for KSI 40, MZ, H8-5, ZK, OIT 40



KSI 40, ZK, OIT 40

- 1 RAL 9006 White aluminium
- 2 RAL 8028 Terra brown
- 3 RAL 8003 Clay brown
- 4 RAL 7040 Window grey
- 5 RAL 7035 Light grey
- 6 RAL 7016 Anthracite grey
- 7 RAL 6005 Moss green
- 8 RAL 5014 Pigeon blue
- 9 RAL 3003 Ruby red
- 10 RAL 1015 Light ivory

MZ, H8-5

- 11 RAL 9016 Traffic white
- 5 RAL 7035 Light grey
- 6 RAL 7016 Anthracite grey

RAL to choose

All doors are optionally available in RAL to choose and metallic colours.

Please note:

All colours based on RAL. The colours and surface finishes shown are subject to the limitations of the printing process and cannot be regarded as binding. **Please consult with your local Hörmann specialised dealer.**

Decograin surface finish

for KSI Thermo46, MZ Thermo46, MZ Thermo65, FS Thermo65, Thermo65, KSI 40, ZK, OIT 40

Decors for outdoor and indoor use



Decors for KSI Thermo46, MZ Thermo65, MZ Thermo46, FS Thermo65, Thermo65

- 1** Golden Oak: medium brown, golden yellow oak decor
- 2** Dark Oak: walnut-coloured oak decor
- 3** Night Oak: dark, intense oak design
- 4** Winchester Oak: natural-coloured knotty oak decor
- 5** Titan Metallic CH 703 with a metallic effect

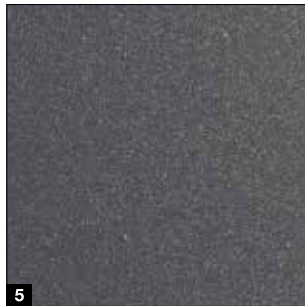

Decors for KSI 40, ZK, OIT 40

- 1** Golden Oak: medium brown, golden yellow oak decor
- 2** Dark Oak: walnut-coloured oak decor
- 3** Night Oak: dark, intense oak design
- 4** Winchester Oak: natural-coloured knotty oak decor
- 6** White Ash
- 7** Light Oak
- 8** Beech

Decors for indoor use only

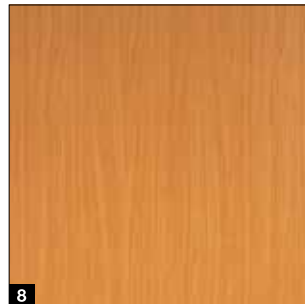

Please note:

The colours and surface finishes shown are subject to the limitations of the printing process and cannot be regarded as binding. **Please consult with your local Hörmann specialised dealer.**

Size range

Standard sizes

Door type	KSI Thermo46	FS Thermo65	Thermo65	MZ Thermo46	MZ Thermo65	KSI 40-1	H3 OD	H8-5	MZ-1	ZK-1 / ZK-2	OIT 40-1 / OIT-2
Hatches											
750 × 875								●			
800 × 800								●			
875 × 875								●			
875 × 1000								●			
875 × 1250								●			
Single-leaf doors											
625 × 2000										●	●
625 × 2125										●	●
750 × 1750								●	●		
750 × 1875						●		●	●	●	●
750 × 2000						●	●	●	●	●	●
750 × 2125						●	●			●	●
800 × 1800								●	●		
800 × 1875								●	●		
800 × 2000								●	●		
875 × 1750								●	●		
875 × 1800								●	●		
875 × 1875						●	●	●	●	●	●
875 × 2000	■	■		■	■	●	●	●	●	●	●
875 × 2125	■	■		■	■	●	●	●	●	●	●
1000 × 1875						●		●	●	●	●
1000 × 2000	■	■		■	■	●	●	●	●	●	●
1000 × 2100	■	■	■	■	■						
1000 × 2125	■	■		■	■	●	●	●	●	●	●
1150 × 2200	■	■	■	■	■						
1100 × 2100	■	■	■	■	■						
1125 × 2000							●			●	
1125 × 2125							●		●	●	●
1250 × 2000									●	●	●
1250 × 2125									●	●	●
Double-leaf doors											
1500 × 2000							●		●	●	●
1500 × 2125							●			●	●
1750 × 2000							●		●	●	●
1750 × 2125							●			●	●
2000 × 2000							●		●	●	●
2000 × 2125							●		●	●	●
2125 × 2125							●				
2250 × 2250							●				

Ordering sizes

■ = Overall frame dimension

● = Nominal size

Please state handing
on order.



Left-hand hinged



Right-hand hinged



Traffic leaf left-hand hinged



Traffic leaf right-hand hinged

All dimensions in mm

Door sizing and fitting variants

KSI Thermo46, MZ Thermo65 / MZ Thermo46, FS Thermo65, Thermo65

Vertical view

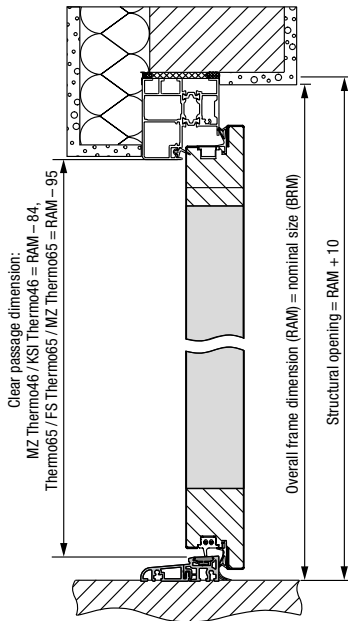

Horizontal view

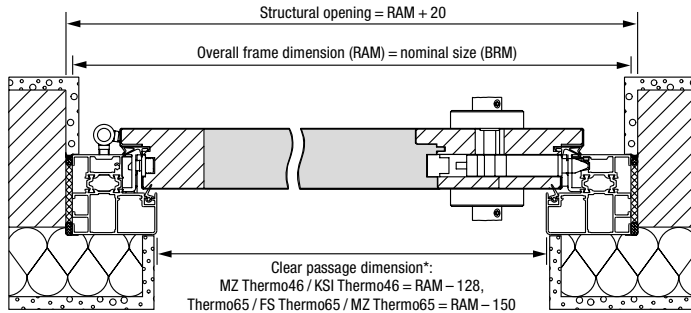

Fitting variants

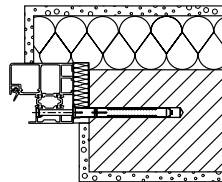

Block frame
Fitting to brickwork
Countersunk fitting

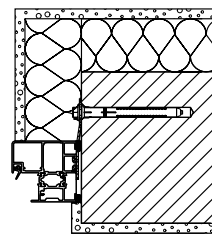

Block frame
Anchor fitting

* With an opening angle of 90° and without handles and lever handles, the clear passage width is reduced by 2 mm.

KSI 40

Vertical view

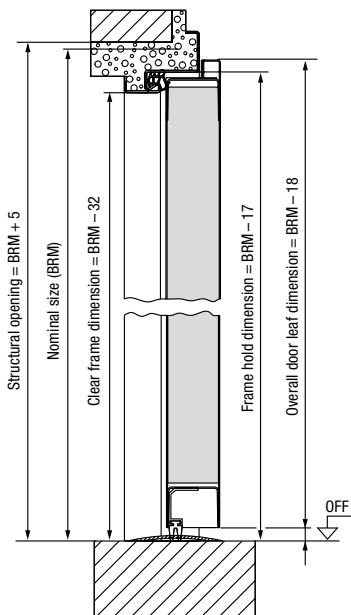

Horizontal view

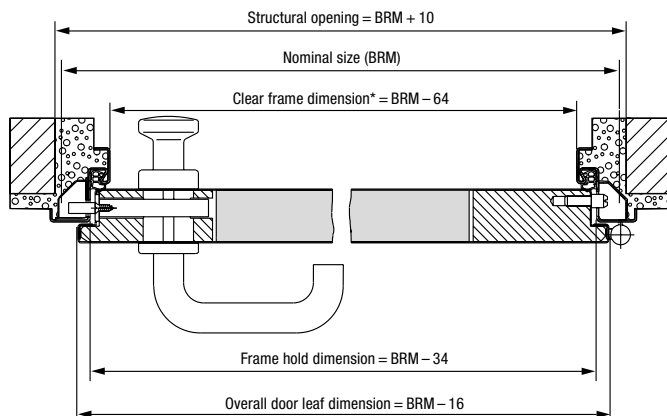

Fitting variants

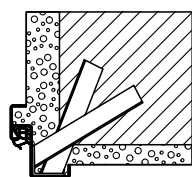

Fitting with through
plugs

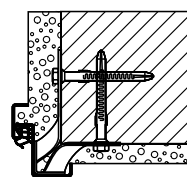

Fitting with grouting
lugs

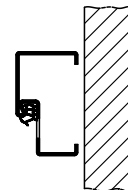

Block frame for fitting
in the opening
(profile 21101)

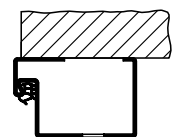

Block frame for fitting to
the wall (profile 006)
(tested on the opposite
hinge side)

* With an opening angle of 90° and without handles and lever handles, the clear passage width is reduced by 2 mm.

All dimensions in mm

Door sizing and fitting variants

MZ, H8-5

Vertical view

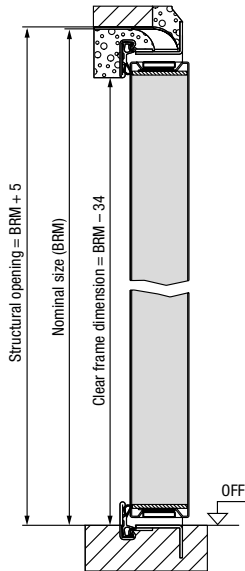

Horizontal view

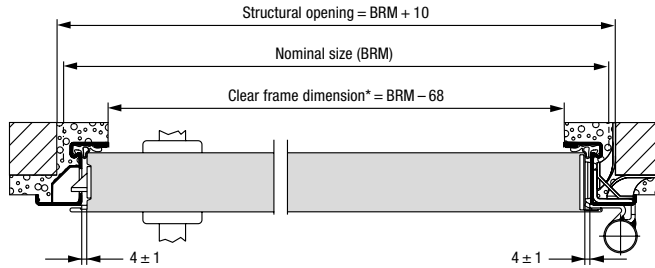

* With an opening angle of 90° and without handles and lever handles, the clear passage width is reduced by 25 mm.

Fitting variants

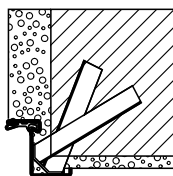

Fitting with through plugs

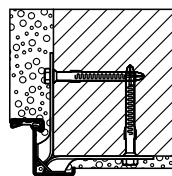

Fitting with grouting lugs

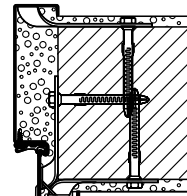

Corner and counter frame
Fitting with grouting lugs

H3 OD

Vertical view

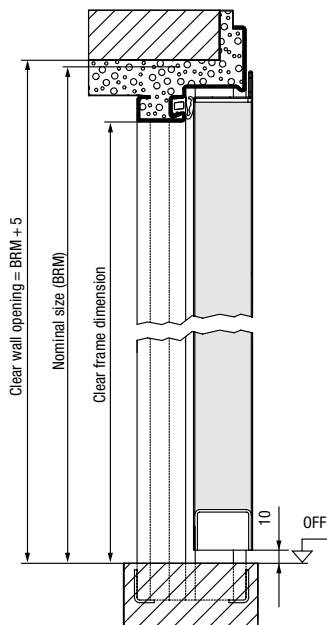

Horizontal view

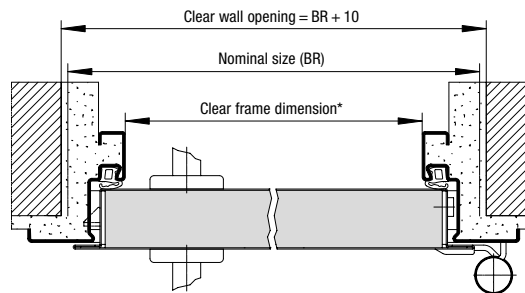

* With an opening angle of 90° and without handles and lever handles, the clear passage width is reduced by 113 mm (thin rebate) or 103 mm (thick rebate).

Fitting variants

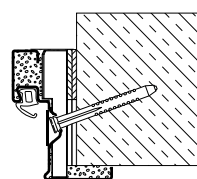

Diagonal fixing
(Unplastered brickwork / concrete)

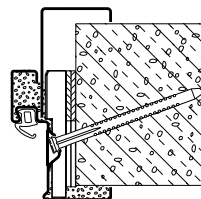

Diagonal fixing
With counter frame Vario B53 as a 2-part profile frame
(Gas concrete)

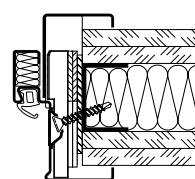

Diagonal fixing
(Gas concrete)

ZK, OIT

Vertical view

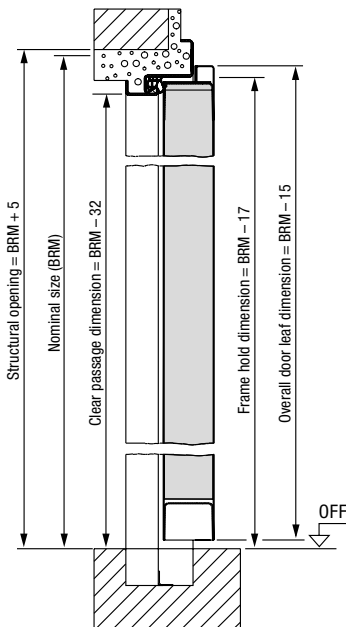

Horizontal view

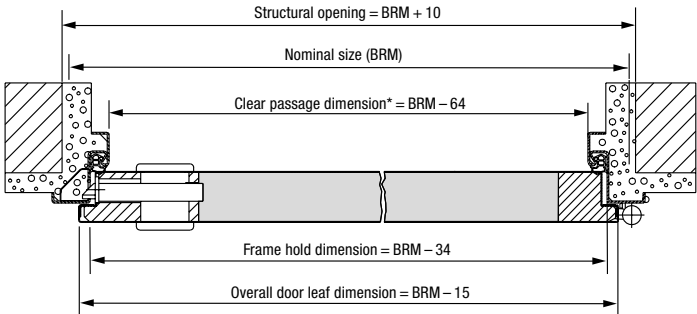

* With an opening angle of 90° and without handles and lever handles, the clear passage width is reduced by 2 mm, for a double-leaf door by 4 mm.

Fitting variants

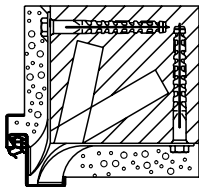

Corner frame
Fitting to brickwork
Through plugs

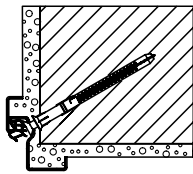

Special corner frame
Plug-and-screw fitting
through the groove
bottom

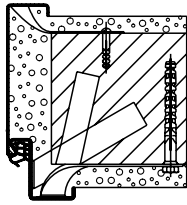

Profile frame
Fitting to brickwork
Through plugs

Experience Hörmann quality in new construction and modernisation

Hörmann products have impressive durability and high functionality. You can easily plan for new construction as well as modernisation. The carefully coordinated solutions make your home more beautiful, more secure and more comfortable.

GARAGE DOORS. GATE AND DOOR OPERATORS. ENTRANCE DOORS. RESIDENTIAL INTERNAL DOORS. STEEL DOORS. FRAMES. STORAGE SPACE SYSTEMS.



Some of the products shown are equipped with special equipment and do not always correspond to the standard versions. The surface finishes and colours shown are subject to the limitations of the printing process and cannot be regarded as binding. All rights reserved. No part may be reproduced without our prior permission. Subject to changes.